

## RECOMMENDED SPARE PARTS FOR 2 TO 5 YEARS' OPERATING TIME

Type	Max. stages	Pump wear parts kit S, NS- execution	Pump wear parts kit NES- execution
BM 3A / 5A	12		96440231
	15	055504	
	24	105546	
	25		96440230
	30	105547	
	33		96440229
	39	105059	
	45		96440228
	48	095059	
	60	095060	96439727
BM 8A	10	96428935	96428939
	18	96428936	96428940
	25	96428937	96428941
	37	96428938	
BM 17	5	96440234	96440235
	16	96440232	96440233
	24	96440236	96440237
	40	96440238	96440239
BM 30	5	96440240	96440241
	16	96440242	96440243
	27	96440244	96440245
	35	96440246	96024447
BM 46	6	96440248	96440249
	10	96440250	96440251
	16	96440252	96440253
	20	96440254	96440255
BM 60	6	96440369	96440370
	10	96440371	96440372
	16	96440373	96440374
	20	96440375	96440376
BM 77	8	96440256	96440257
	14	96440258	96440259
	20	96440260	96440261
BM 95	8	96440715	96440718
	14	96440716	96440719
	20	96440717	96440720
BM125	4	96440262	96440263
	6	96440264	96440265
	9	96440266	96440267

Number of pumps	No. of wear parts kit	Motor complete	Motor Cable
1-2	1	1	1
3-5	2	1	1
6-10	3	1	1
11-20	4	2	2

## RECOMMENDED SPARE PARTS FOR 2 TO 5 YEARS' OPERATING TIME

### PUMP WEAR PARTS KIT

Type	Max. stages	Pump wear parts kit	
		NS execution	NES execution
BME(T) 17	5	96421723	96440235
	16	96421724	96440233
	24	96421725	96440237
	40	96440238	96440239
BME(T) 30	5	96421732	96440241
	16	96421733	96440243
	27	96421734	96440245
BME(T) 46	6	96440248	96440249
	10	96440250	96440251
	16	96440252	96440253
BME(T) 60	6	96440369	96440370
	10	96440371	96440372
	16	96440373	96440374
	22	96440375	96440376

### PULLEY HEAD

Description	Units	Part number
Rotating shaft w/ thrust bearing	1	00145948
Stationary thrust bearing	1	00145994
Shaft seal	1	00ID2956
Ball bearings	2	00ID0380
Gasket kit	1 set	00145177

### TURBINE (BMET ONLY)

Description	Units	Part number
Rotating shaft w/ thrust bearing	1	00145947
Stationary thrust bearing	1	00145994
Gasket kit	1 set	00145178

### V- BELTS

DN nominal diameter [mm]	Type	Part number
1320	XPB	96405537
1340	XPB	96405538
1400	XPB	96405539
1410	XPB	96405540
1450	XPB	96415218
1500	XPB	96405541
1510	XPB	96405542
1550	XPB	96415219
1590	XPB	96405543
1600	XPB	96405544
1650	XPB	96415220
1690	XPB	96405545

### OIL FOR PULLEY HEAD

Description	Part number
1 litre	00145164

For each BME(T) it is recommended to use 1 set of all spare parts including 1 set of V-belts and 1 set of motor bearings.

## RECOMMENDED SPARE PARTS FOR 2 AND 5 YEARS' OPERATING TIME



Type	Kw	Shaft seal BBUE	Shaft seal BQQE	Shaft seal GQQE	Shaft sleeve	Impeller* left	Impeller* right	ND-Motor bearing	DE-Motor bearing
CDM 125-155	2.2	S0810108	96432382	96432384	S0810073	S0599212	S0597848	S9503495	S0503002
CDM 125-180	2.2	S0810108	96432382	96432384	S0810073	S0599212	S0597848	S9503495	S0503002
CDM 125-198	3.0	S0810108	96432382	96432384	S0810073	S0599212	S0597848	S9503495	S0503002
CDM 125-213	4.0	S0810108	96432382	96432384	S0810073	S0599212	S0597848	S0505364	S9503495
CDM 125-225	5.5	S0810108	96432382	96432384	S0810073	S0599212	S0597848	S0505364	S9503495
CDM 150-150	2.2	S0810108	96432382	96432384	S0810073	S0599115	S0597805	S9503495	S0503002
CDM 150-188	2.2	S0810108	96432382	96432384	S0810073	S0599115	S0597805	S9503495	S0503002
CDM 150-201	3.0	S0810108	96432382	96432384	S0810073	S0599115	S0597805	S9503495	S0503002
CDM 150-214	4.0	S0810108	96432382	96432384	S0810073	S0599115	S0597805	S0505364	S9503495
CDM 150-229	5.5	S0810108	96432382	96432384	S0810073	S0599115	S0597805	S0505364	S9503495
CDM 150-242	7.5	S0810108	96432382	96432384	S0810073	S0599115	S0597805	S3503630	S3505363
CDM 150-248	11.0	S0810108	96432382	96432384	S0810073	S0599115	S0597805	S3503630	S3505363
CDM 200-195	5.5	S0810109	96432381	96432383	S0594644	S0599239	S0597783	S0505364	S9503495
CDM 200-210	7.5	S0810109	96432381	96432383	S0594644	S0599239	S0597783	S3503630	S3505363
CDM 200-240	11.0	S0810109	96432381	96432383	S0594644	S0599239	S0597783	S3503630	S3505363
CDM 200-263	15.0	S0810109	96432381	96432383	S0594644	S0599239	S0597783	S3503630	S3505363
CDM 200-271	18.5	S0810109	96432381	96432383	S0594644	S0599239	S0597783	S9505358	S7505363
CDM 200-278	22.0	S0810109	96432381	96432383	S0594644	S0599239	S0597783	S9505358	S7505363
CDM 210-240	18.5	S0810109	96432381	96432383	S0594644	S0542016	S0541974	S9505358	S7505363
CDM 210-257	22.0	S0810109	96432381	96432383	S0594644	S0542016	S0541974	S9505358	S7505363
CDM 210-287	30.0	S0810109	96432381	96432383	S0594644	S0542016	S0541974	S9505358	S9505358
CDM 210-305	37.0	S0810109	96432381	96432383	S0594644	S0542016	S0541974	S0505365	S0505359
CDM 210-313	45.0	S0810109	96432381	96432383	S0594644	S0542016	S0541974	S0505365	S0505359

\* The part number of the impeller is the impeller with max. diameter. Inform about the actual diameter when ordering.

Number of pumps	Number of shaft seals	Number of shaft sleeves	Number of impellers	Number of ND bearings	Number of DE bearings
1	1	1	1	1	1
2	1	1	1	2	2
3	2	2	2	3	3
4	2	2	2	4	4
5	2	2	2	5	5
6	3	3	3	6	6
7	3	3	3	7	7
8	3	3	3	8	8
9	3	3	3	9	9
10	3	3	3	10	10

# CLM 100, 125, 150, 200

## RECOMMENDED SPARE PARTS FOR 2 AND 5 YEARS' OPERATING TIME

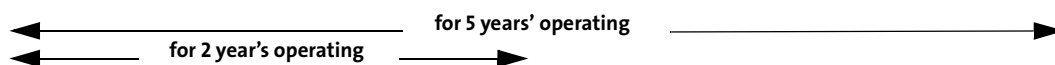

Type	kW	Shaft seal DAQE	Shaft seal BBUE	Shaft seal BQQE	Shaft seal GQQE	Shaft sleeve	Impeller*	DE-Motor bearing	ND-Motor bearing
		G-version							
CLM 65-110	0.55	S0524301				S0594628	S0597929	S9502995	S1505362
CLM 65-135	0.55	S0524301				S0594628	S0597929	S9502995	S1505362
CLM 65-142	0.75	S0524301				S0594628	S0597929	S9502995	S1505362
CLM 65-157	0.75	S0524301				S0594628	S0597929	S9502995	S1505362
CLM 65-176	1.1	S0524301				S0594628	S0597929	S3505145	S0503002
CLM 65-195	1.5	S0524301				S0594628	S0597929	S3505145	S0503002
CLM 80-120	0.75	S0524301				S0594636	S0597880	S9502995	S1505362
CLM 80-150	0.75	S0524301				S0594636	S0597880	S9502995	S1505362
CLM 80-170	1.1	S0524301				S0594636	S0597880	S3505145	S0503002
CLM 80-183	1.5	S0524301				S0594636	S0597880	S3505145	S0503002
CLM 80-192	2.2	S0524301				S0594636	S0597880	S9503495	S0503002
CLM 80-210	3.0	S0524301				S0594636	S0597880	S9503495	S0503002
CLM 100-158	2.2	S0524441	S0810108	96432382	96432384	S0810073	S0597848	S9503495	S0503002
CLM 100-178	2.2	S0524441	S0810108	96432382	96432384	S0810073	S0597848	S9503495	S0503002
CLM 100-203	3.0	S0524441	S0810108	96432382	96432384	S0810073	S0597848	S9503495	S0503002
CLM 100-217	4.0	S0524441	S0810108	96432382	96432384	S0810073	S0597848	S0505364	S9503495
CLM 100-225	5.5	S0524441	S0810108	96432382	96432384	S0810073	S0597848	S0505364	S9503495
CLM 125-160	2.2	S0524441	S0810108	96432382	96432384	S0810073	S0597805	S9503495	S0503002
CLM 125-177	2.2	S0524441	S0810108	96432382	96432384	S0810073	S0597805	S9503495	S0503002
CLM 125-197	3.0	S0524441	S0810108	96432382	96432384	S0810073	S0597805	S9503495	S0503002
CLM 125-211	4.0	S0524441	S0810108	96432382	96432384	S0810073	S0597805	S0505364	S9503495
CLM 125-228	5.5	S0524441	S0810108	96432382	96432384	S0810073	S0597805	S0505364	S9503495
CLM 125-242	7.5	S0524441	S0810108	96432382	96432384	S0810073	S0597805	S3503630	S7505363
CLM 150-195	5.5	S0524492	S0810109	96432381	96432383	S0594644	S0597783	S0505364	S9503495
CLM 150-216	7.5	S0524492	S0810109	96432381	96432383	S0594644	S0597783	S3503630	S3505363
CLM 150-242	11.0	S0524492	S0810109	96432381	96432383	S0594644	S0597783	S3503630	S3505363
CLM 150-264	15.0	S0524492	S0810109	96432381	96432383	S0594644	S0597783	S3503630	S3505363
CLM 150-271	18.5	S0524492	S0810109	96432381	96432383	S0594644	S0597783	S9505358	S3505363
CLM 150-278	22.0	S0524492	S0810109	96432381	96432383	S0594644	S0597783	S9505358	S3505363
CLM 200-240	18.5	S0524492	S0810109	96432381	96432383	S0594644	S0541974	S9505358	S3505363
CLM 200-261	22.0	S0524492	S0810109	96432381	96432383	S0594644	S0541974	S9505358	S3505363
CLM 200-282	30.0	S0524492	S0810109	96432381	96432383	S0594644	S0541974	S9505358	S9505358
CLM 200-300	37.0	S0524492	S0810109	96432381	96432383	S0594644	S0541974	S0505365	S0505359
CLM 200-315	45.0	S0524492	S0810109	96432381	96432383	S0594644	S0541974	S0505365	S0505359

\* The part number of the impeller is the impeller with max. diameter. Inform about the actual diameter when ordering.

Number of pumps	Number of shaft seals	Number of shaft sleeves	Number of impellers	Number of ND bearings	Number of DE bearings
1	1	1	1	1	1
2	1	1	1	2	2
3	2	2	2	3	3
4	2	2	2	4	4
5	2	2	2	5	5
6	3	3	3	6	6
7	3	3	3	7	7
8	3	3	3	8	8
9	3	3	3	9	9
10	3	3	3	10	10

## RECOMMENDED SPARE PARTS FOR 2 TO 5 YEARS' OPERATING TIME

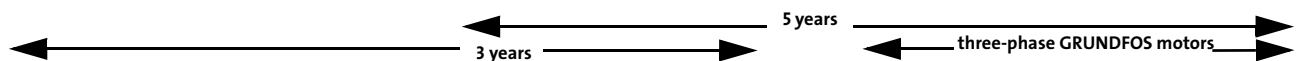

Type	Wear part kit	Wear part kit	Wear part kit	Shaft seal kit	Gasket kit	Gasket kit	Chamber stack	Motor bearings 50 Hz			Motor bearings 60 Hz				
	Sic/Sic	Bronze	Graflon		EPDM	FKM	Sic/Sic	ND-side	DE-side	ND-side	DE-side				
CR/CRI 1-2	96455095	96455102	96460140	Table 1	96455090	96455091	96453485	96490769	96490842	96490769	96490842				
CR/CRI 1-3	96455095	96455102	96460140				96453486	96490769	96490842	96490769	96490842				
CR/CRI 1-4	96455095	96455102	96460140				96453487	96490769	96490842	96490769	96490842				
CR/CRI 1-5	96455095	96455102	96460140				96453488	96490769	96490842	96490769	96490842				
CR/CRI 1-6	96455095	96455102	96460140				96453489	96490769	96490842	96490769	96490842				
CR/CRI 1-7	96455095	96455102	96460140				96453490	96490769	96490842	96490769	96490842				
CR/CRI 1-8	96455095	96455102	96460140				96453491	96490769	96490842	96490769	96490842				
CR/CRI 1-9	96455095	96455102	96460140				96453492	96490769	96490842	96490769	96490842				
CR/CRI 1-10	96455092	96455104	96455110				96453493	96490769	96490842	96490769	96490842				
CR/CRI 1-11	96455092	96455104	96455110				96453494	96490769	96490842	96490769	96490842				
CR/CRI 1-12	96455092	96455104	96455110				96453495	96490769	96490842	96490769	96490842				
CR/CRI 1-13	96455092	96455104	96455110				96453496	96490769	96490842	96490769	96490842				
CR/CRI 1-15	96455092	96455104	96455110				96453497	96490769	96490842	96449808	96490848				
CR/CRI 1-17	96455092	96455104	96455110				96453498	96490769	96490847	96449808	96490848				
CR/CRI 1-19	96455092	96455104	96455110				96453499	96490769	96490847	96490844	96490848				
CR/CRI 1-21	96455093	96455105	96455111				96453500	96490769	96490847	96490844	96490848				
CR/CRI 1-23	96455093	96455105	96455111				96453501	96490769	96490847	96490844	96490848				
CR/CRI 1-25	96455093	96455105	96455111				96453502	96449808	96490848	96490844	96490848				
CR/CRI 1-27	96455093	96455105	96455111				96453503	96449808	96490848	96490844	96490848				
CR/CRI 1-30	96455094	96455106	96455112				96453504	96449808	96490848						
CR/CRI 1-33	96455094	96455106	96455112				96453505	96490844	96490848						
CR/CRI 1-36	96455094	96455106	96455112				96453506	96490844	96490848						
Kit CRN 1-2	96455095	96455102	96460140							96453507	96490769	96490842	96490769	96490842	
Kit CRN 1-3	96455095	96455102	96460140							96453508	96490769	96490842	96490769	96490842	
Kit CRN 1-4	96455095	96455102	96460140							96453509	96490769	96490842	96490769	96490842	
Kit CRN 1-5	96455095	96455102	96460140							96453510	96490769	96490842	96490769	96490842	
Kit CRN 1-6	96455095	96455102	96460140							96453511	96490769	96490842	96490769	96490842	
Kit CRN 1-7	96455095	96455102	96460140							96453512	96490769	96490842	96490769	96490842	
Kit CRN 1-8	96455095	96455102	96460140							96453513	96490769	96490842	96490769	96490842	
Kit CRN 1-9	96455095	96455102	96460140							96453514	96490769	96490842	96490769	96490842	
Kit CRN 1-10	96455092	96455104	96455110							96453515	96490769	96490842	96490769	96490842	
Kit CRN 1-11	96455092	96455104	96455110							96453516	96490769	96490842	96490769	96490842	
Kit CRN 1-12	96455092	96455104	96455110							96453517	96490769	96490842	96490769	96490842	
Kit CRN 1-13	96455092	96455104	96455110							96453518	96490769	96490842	96490769	96490842	
Kit CRN 1-15	96455092	96455104	96455110							96453519	96490769	96490842	96449808	96490848	
Kit CRN 1-17	96455092	96455104	96455110							96453520	96490769	96490847	96449808	96490848	
Kit CRN 1-19	96455092	96455104	96455110				96453521	96490769	96490847	96490844	96490848				
Kit CRN 1-21	96455093	96455105	96455111				96453522	96490769	96490847	96490844	96490848				
Kit CRN 1-23	96455093	96455105	96455111				96453523	96490769	96490847	96490844	96490848				
Kit CRN 1-25	96455093	96455105	96455111				96453524	96449808	96490848	96490844	96490848				
Kit CRN 1-27	96455093	96455105	96455111				96453525	96449808	96490848	96490844	96490848				
Kit CRN 1-30	96455094	96455106	96455112				96453526	96449808	96490848						
Kit CRN 1-33	96455094	96455106	96455112				96453527	96490844	96490848						
Kit CRN 1-36	96455094	96455106	96455112				96453528	96490844	96490848						

Table 1	Shaft seal type	HUBE	HUBV	HUUE	HUUV	HQQE	HQQV	HQBE	HQBV
	Part number	96455082	96455083	96455084	96455085	96455086	96455087	96455088	96455089

### Recommended spare parts for tenders

Number of pumps	Number of wear part kit	Number of shaft seal kit	Number of gasket kit	Number of chamber stack	Number of	
					ND bearings	DE bearings
1	1	1	1	1	1	1
2	1	1	1	1	2	2
3	2	2	2	2	3	3
4	2	2	2	2	4	4
5	2	2	2	2	5	5
6	3	3	3	3	6	6
7	3	3	3	3	7	7
8	3	3	3	3	8	8
9	3	3	3	3	9	9
10	3	3	3	3	10	10

## RECOMMENDED SPARE PARTS FOR 2 TO 5 YEARS' OPERATING TIME

← 3 years      ← 5 years      ← 3 phase GRUNDFOS motors →

Type	Wear part kit	Wear part kit	Wear part kit	Shaft seal kit	Gasket kit	Gasket kit	Chamber stack	Motor bearings 50 Hz		Motor bearings 60 Hz			
	Sic/Sic	Bronze	Graflon		EPDM	FKM		Sic/Sic	ND-side	DE-side	ND-side	DE-side	
CR/CRI 3-2	96455095	96455102	96460140	Table 1	96455090	96455091	96453529	96490769	96490842	96490769	96490842		
CR/CRI 3-3	96455095	96455102	96460140				96453530	96490769	96490842	96490769	96490842		
CR/CRI 3-4	96455095	96455102	96460140				96453531	96490769	96490842	96490769	96490842		
CR/CRI 3-5	96455095	96455102	96460140				96453532	96490769	96490842	96490769	96490842		
CR/CRI 3-6	96455095	96455102	96460140				96453533	96490769	96490842	96490769	96490842		
CR/CRI 3-7	96455095	96455102	96460140				96453534	96490769	96490842	96490769	96490842		
CR/CRI 3-8	96455095	96455102	96460140				96453535	96490769	96490842	96490769	96490842		
CR/CRI 3-9	96455095	96455102	96460140				96453536	96490769	96490842	96490842	96490848		
CR/CRI 3-10	96455092	96455104	96455110				96453537	96490769	96490842	96449808	96490848		
CR/CRI 3-11	96455092	96455104	96455110				96453538	96490769	96490842	96449808	96490848		
CR/CRI 3-12	96455092	96455104	96455110				96453539	96490769	96490842	96490844	96490848		
CR/CRI 3-13	96455092	96455104	96455110				96453540	96490769	96490842	96490844	96490848		
CR/CRI 3-15	96455092	96455104	96455110				96453541	96490769	96490842	96490844	96490848		
CR/CRI 3-17	96455092	96455104	96455110				96453542	96449808	96490848	96490844	96490848		
CR/CRI 3-19	96455092	96455104	96455110				96453543	96449808	96490848	96490844	96457053		
CR/CRI 3-21	96455093	96455105	96455111				96453544	96490844	96490848	96490844	96457053		
CR/CRI 3-23	96455093	96455105	96455111				96453545	96490844	96490848	96490844	96457053		
CR/CRI 3-25	96455093	96455105	96455111				96453546	96490844	96490848	96457052	96467322		
CR/CRI 3-27	96455093	96455105	96455111				96453547	96490844	96490848				
CR/CRI 3-29	96455094	96455106	96455112				96453548	96490844	96490848				
CR/CRI 3-30	96455094	96455106	96455112				96453549	96490844	96457053				
CR/CRI 3-33	96455094	96455106	96455112				96453550	96490844	96457053				
CR/CRI 3-36	96455094	96455106	96455112				96453551	96490844	96457053				
Kit CRN 3-2	96455095	96455102	96460140						96453552	96490769	96490842	96490769	96490842
Kit CRN 3-3	96455095	96455102	96460140						96453553	96490769	96490842	96490769	96490842
Kit CRN 3-4	96455095	96455102	96460140						96453554	96490769	96490842	96490769	96490842
Kit CRN 3-5	96455095	96455102	96460140						96453555	96490769	96490842	96490769	96490842
Kit CRN 3-6	96455095	96455102	96460140						96453556	96490769	96490842	96490769	96490842
Kit CRN 3-7	96455095	96455102	96460140						96453557	96490769	96490842	96490769	96490842
Kit CRN 3-8	96455095	96455102	96460140						96453558	96490769	96490842	96490769	96490842
Kit CRN 3-9	96455095	96455102	96460140						96453559	96490769	96490842	96490769	96490842
Kit CRN 3-10	96455092	96455104	96455110						96453560	96490769	96490842	96490769	96490842
Kit CRN 3-11	96455092	96455104	96455110						96453561	96490769	96490842	96490769	96490842
Kit CRN 3-12	96455092	96455104	96455110						96453562	96490769	96490842	96490769	96490842
Kit CRN 3-13	96455092	96455104	96455110						96453563	96490769	96490842	96490769	96490842
Kit CRN 3-15	96455092	96455104	96455110						96453564	96490769	96490842	96449808	96490848
Kit CRN 3-17	96455092	96455104	96455110			96453565	96490769	96490847	96449808	96490848			
Kit CRN 3-19	96455092	96455104	96455110			96453566	96490769	96490847	96490844	96490848			
Kit CRN 3-21	96455093	96455105	96455111			96453567	96490769	96490847	96490844	96490848			
Kit CRN 3-23	96455093	96455105	96455111			96453568	96490769	96490847	96490844	96490848			
Kit CRN 3-25	96455093	96455105	96455111			96453569	96449808	96490848	96490844	96490848			
Kit CRN 3-27	96455093	96455105	96455111			96453570	96449808	96490848	96490844	96457053			
Kit CRN 3-29	96455094	96455106	96455112			96453571	96449808	96490848					
Kit CRN 3-30	96455094	96455106	96455112			96453572	96490844	96490848					
Kit CRN 3-33	96455094	96455106	96455112			96453573	96490844	96490848					
Kit CRN 3-36	96455094	96455106	96455112			96453574							

Table 1	Shaft seal type	HUBE	HUBV	HUUE	HUUV	HQQE	HQQV	HQBE	HQBV
	Part number	96455082	96455083	96455084	96455085	96455086	96455087	96455088	96455089

Recommended spare parts for tenders

Number of pumps	Number of wear part kit	Number of shaft seal kit	Number of gasket kit	Number of chamber stack	Number of	
					ND bearings	DE bearings
1	1	1	1	1	1	1
2	1	1	1	1	2	2
3	2	2	2	2	3	3
4	2	2	2	2	4	4
5	2	2	2	2	5	5
6	3	3	3	3	6	6
7	3	3	3	3	7	7
8	3	3	3	3	8	8
9	3	3	3	3	9	9
10	3	3	3	3	10	10

## RECOMMENDED SPARE PARTS FOR 2 TO 5 YEARS' OPERATING TIME



Type	Wear part kit	Wear part kit	Wear part kit	Shaft seal kit	Gasket kit		Chamber stack	Motor bearings 50 Hz		Motor bearings 60 Hz			
	Sic/Sic	Bronze	Graflon		EPDM	FKM		Sic/Sic	ND-side	DE-side	ND-side	DE-side	
CR/CRI 5-2	96455096	96455103	96460141	Table 1	96455090	96455091	96453575	96490769	96490842	96490769	96490842		
CR/CRI 5-3	96455096	96455103	96460141				96453576	96490769	96490842	96490769	96490842		
CR/CRI 5-4	96455096	96455103	96460141				96453577	96490769	96490842	96490769	96490842		
CR/CRI 5-5	96455096	96455103	96460141				96453578	96490769	96490842	96490844	96490848		
CR/CRI 5-6	96455096	96455103	96460141				96453579	96490769	96490842	96490844	96490848		
CR/CRI 5-7	96455096	96455103	96460141				96453580	96490769	96490842	96490844	96490848		
CR/CRI 5-8	96455097	96460106	96460142				96453581	96490769	96490842	96490844	96490848		
CR/CRI 5-9	96455097	96460106	96460142				96453582	96490844	96490848	96490844	96490848		
CR/CRI 5-10	96455097	96460106	96460142				96453583	96490844	96490848	96490844	96457053		
CR/CRI 5-11	96455097	96460106	96460142				96453584	96490844	96490848	96490844	96457053		
CR/CRI 5-12	96455097	96460106	96460142				96453585	96490844	96490848	96490844	96457053		
CR/CRI 5-13	96455098	96455107	96455113				96453586	96490844	96490848	96457052	96467322		
CR/CRI 5-14	96455098	96455107	96455113				96453587	96490844	96490848	96457052	96467322		
CR/CRI 5-15	96455098	96455107	96455113				96453588	96490844	96490848	96457052	96467322		
CR/CRI 5-16	96455098	96455107	96455113				96453589	96490844	96490848	96457052	96467322		
CR/CRI 5-18	96455099	96455108	96455114				96453590	96490844	96457053	96457052	96463976		
CR/CRI 5-20	96455099	96455108	96455114				96453591	96490844	96457053	96457052	96463976		
CR/CRI 5-22	96455099	96455108	96455114				96453592	96457052	96467322	96457052	96463976		
CR/CRI 5-24	96455101	96460107	96460143				96453593	96457052	96467322	96457052	96463976		
CR/CRI 5-26	96455101	96460107	96460143				96453594	96457052	96467322				
CR/CRI 5-29	96455100	96455109	96455115				96453595	96457052	96467322				
CR/CRI 5-32	96455100	96455109	96455115				96453596	96457052	96463976				
CR/CRI 5-36	96455100	96455109	96455115				96453597	96457052	96463976				
Kit CRN 5-2	96455096	96455103	96460141						96453598	96490769	96490842	96490769	96490842
Kit CRN 5-3	96455096	96455103	96460141						96453599	96490769	96490842	96490769	96490842
Kit CRN 5-4	96455096	96455103	96460141						96453600	96490769	96490842	96490769	96490842
Kit CRN 5-5	96455096	96455103	96460141						96453601	96490769	96490842	96490844	96490848
Kit CRN 5-6	96455096	96455103	96460141						96453602	96490769	96490842	96490844	96490848
Kit CRN 5-7	96455096	96455103	96460141						96453603	96490769	96490842	96490844	96490848
Kit CRN 5-8	96455097	96460106	96460142						96453604	96490769	96490842	96490844	96490848
Kit CRN 5-9	96455097	96460106	96460142						96453605	96490844	96490848	96490844	96490848
Kit CRN 5-10	96455097	96460106	96460142						96453606	96490844	96490848	96490844	96457053
Kit CRN 5-11	96455097	96460106	96460142						96453607	96490844	96490848	96490844	96457053
Kit CRN 5-12	96455097	96460106	96460142						96453608	96490844	96490848	96490844	96457053
Kit CRN 5-13	96455098	96455107	96455113						96453609	96490844	96490848	96457052	96467322
Kit CRN 5-14	96455098	96455107	96455113						96453610	96490844	96490848	96457052	96467322
Kit CRN 5-15	96455098	96455107	96455113			96453611	96490844	96490848	96457052	96467322			
Kit CRN 5-16	96455098	96455107	96455113			96453612	96490844	96490848	96457052	96467322			
Kit CRN 5-18	96455099	96455108	96455114			96453613	96490844	96457053	96457052	96463976			
Kit CRN 5-20	96455099	96455108	96455114			96453614	96490844	96457053	96457052	96463976			
Kit CRN 5-22	96455099	96455108	96455114			96453615	96457052	96467322	96457052	96463976			
Kit CRN 5-24	96455101	96460107	96460143			96453616	96457052	96467322	96457052	96463976			
Kit CRN 5-26	96455101	96460107	96460143			96453617	96457052	96467322					
Kit CRN 5-29	96455100	96455109	96455115			96453618	96457052	96467322					
Kit CRN 5-32	96455100	96455109	96455115			96453619	96457052	96463976					
Kit CRN 5-36	96455100	96455109	96455115			96453620	96457052	96463976					

Table 1	Shaft seal type	HUBE	HUBV	HUUE	HUVV	HQQE	HQQV	HQBE	HQBV
	Part number	96455082	96455083	96455084	96455085	96455086	96455087	96455088	96455089

### Recommended spare parts for tenders

Number of pumps	Number of wear part kit	Number of shaft seal kit	Number of gasket kit	Number of chamber stack	Number of	
					ND bearings	DE bearings
1	1	1	1	1	1	1
2	1	1	1	1	2	2
3	2	2	2	2	3	3
4	2	2	2	2	4	4
5	2	2	2	2	5	5
6	3	3	3	3	6	6
7	3	3	3	3	7	7
8	3	3	3	3	8	8
9	3	3	3	3	9	9
10	3	3	3	3	10	10

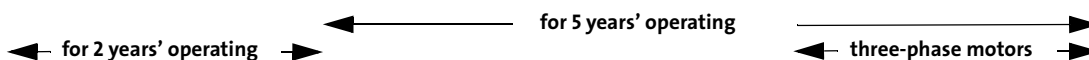

Type	Shaft seal BUBE	Shaft seal AUUE	Service kit BUBE and shaft	Service kit AUUE and shaft	Impeller	ND-Motor bearing	DE-Motor bearing
LM 40-125/142	485351	485113	485352	485125	485250	96490769	96490842
LM 40-160/150	485351	485113	485352	485125	485252	96490769	96490842
LM 40-160/165	485351	485113	485352	485125	485251	96490769	96490842
LM 40-200/191	485351	485113	485352	485125	485262	96490769	96490842
LM 40-200/205	485351	485113	485352	485125	485258	96490769	96490842
LM 50-125/117	485351	485113	485352	485125	485068	96490769	96490842
LM 50-125/128	485351	485113	485352	485125	485007	96490769	96490842
LM 50-160/154	485351	485113	485352	485125	485244	96490769	96490842
LM 50-160/165	485351	485113	485352	485125	485243	96490769	96490842
LM 50-200/198	485351	485113	485352	485125	485246	96490769	96490842
LM 50-200/210	485351	485113	485352	485125	485245	96490844	96490848
LM 65-125/133	485351	485113	485352	485125	485005	96490769	96490842
LM 65-160/158	485351	485113	485352	485125	485059	96490769	96490842
LM 65-160/173	485351	485113	485352	485125	485020	96490844	96490848
LM 65-200/187	485351	485113	485352	485125	485058	96490844	96490848
LM 65-200/202	485351	485113	485352	485125	485016	96490844	96457053
LM 80-125/136	485351	485113	485352	485125	485061	96490769	96490842
LM 80-125/140	485351	485113	485352	485125	485014	96490844	96490848
LM 80-160/162	485351	485113	485352	485125	485060	96490844	96490848
LM 80-160/168	485351	485113	485352	485125	485015	96490844	96457053
LM 80-200/187	485278	485114	485279	485122	485057	96490844	96457053
LM 80-200/200	485278	485114	485279	485122	485056	96490844	96457053
LM 80-200/210	485278	485114	485279	485122	485019	96457052	96457053

Number of pumps	Number of shaft seals	Number of shaft sleeves	Number of impellers	Number of ND bearings	Number of DE bearings
1	1	1	1	1	1
2	1	1	1	2	2
3	2	2	2	3	3
4	2	2	2	4	4
5	2	2	2	5	5
6	3	3	3	6	6
7	3	3	3	7	7
8	3	3	3	8	8
9	3	3	3	9	9
10	3	3	3	10	10

**Example: Spare parts for 4 units LM 50-200/210 with BUBE shaft seal.**

- 2 years of operating: 2 off shaft seal kits: 485351
- 5 years of operating: 2 off service kits: 485352
- 2 off impellers: 485245
- 4 off ND motor bearings: 96490769
- 4 off DE motor bearings: 96490842

## RECOMMENDED SPARE PARTS FOR 2 AND 5 YEARS' OPERATING TIME

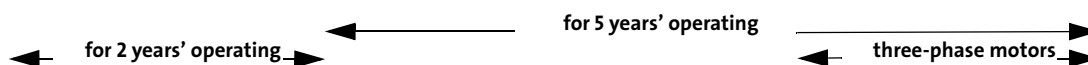

Type	Shaft seal BUBE	Shaft seal AUUE	Service kit BUBE and shaft	Service kit AUUE and shaft	Impeller	ND-Motor bearing	DE-Motor bearing
LP 50-125/132	485351	485113	485352	485125	485254	96490769	96490842
LP 50-125/142	485351	485113	485352	485125	485250	96490844	96490848
LP 50-160/152	485351	485113	485352	485125	485253	96490844	96490848
LP 50-160/165	485351	485113	485352	485125	485251	96490844	96457053
LP 50-200/185	485351	485113	485352	485125	485257	96457052	96457053
LP 50-200/205	485278	485114	485352	485122	485255	96457053	96457054
LP 65-125/104	485351	485113	485352	485125	485069	96490844	96490848
LP 65-125/117	485351	485113	485352	485125	485068	96490844	96490848
LP 65-125/128	485351	485113	485352	485125	485007	96490844	96457053
LP 65-160/154	485351	485113	485352	485125	485244	96457052	96457053
LP 65-160/165	485278	485114	485279	485122	485247	96457053	96457054
LP 65-200/189	485278	485114	485279	485122	485242	96457053	96457054
LP 65-200/202	485278	485114	485279	485122	485241	96457053	96457054
LP 80-125/124	485351	485113	485352	485125	485066	96490844	96457053
LP 80-125/133	485351	485113	485352	485125	485005	96457052	96457053
LP 80-160/149	485278	485114	485279	485122	485063	96457053	96457054
LP 80-160/164	485278	485114	485279	485122	485018	96457053	96457054
LP 80-200/180	485278	485114	485279	485122	485062	00ID3139	00ID3215
LP 80-200/202	485278	485114	485279	485122	485011	00ID6706	00ID6707
LP 100-125/121	485278	485114	485279	485122	485065	96490844	96457053
LP 100-125/130	485278	485114	485279	485122	485064	96457053	96457054
LP 100-125/137	485278	485114	485279	485122	485010	96457053	96457054
LP 100-160/152	485278	485114	485279	485122	485067	00ID3139	00ID3215
LP 100-160/168	485278	485114	485279	485122	485012	00ID6706	00ID6707
LP 100-200/183	485353	485448	485354	485449	485055	00ID6706	00ID6707
LP 100-200/191	485353	485448	485354	485449	485032	00ID6709	00ID6712
LP 100-200/210	485353	485448	485354	485449	485017	00ID6711	00ID6710

Number of pumps	Number of shaft seals	Number of shaft sleeves	Number of impellers	Number of ND bearings	Number of DE bearings
1	1	1	1	1	1
2	1	1	1	2	2
3	2	2	2	3	3
4	2	2	2	4	4
5	2	2	2	5	5
6	3	3	3	6	6
7	3	3	3	7	7
8	3	3	3	8	8
9	3	3	3	9	9
10	3	3	3	10	10

**Example: Spare parts for 4 units LP 50-125/132 with BUBE shaft seal.**

2 years of operating: 2 off shaft seal kits: 485351  
 5 years of operating: 2 off service kits: 485352  
 2 off impellers: 485254  
 4 off ND motor bearings: 96490769  
 4 off DE motor bearings: 96490842

## RECOMMENDED SPARE PARTS FOR 2 AND 5 YEARS' OPERATING TIME

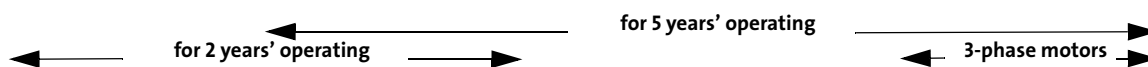

Type	Service kit ceramic	Service kit bronze	Shaft seal BUBE	Shaft seal AUUE/V	Chamber stack ceramic	Chamber stack bronze	ND-Motor bearing	DE-Motor bearing
CR 2-20	405098	405318	405096	985167	405102	405321	96490769	96490842
CR 2-30	405098	405318	405096	985167	405103	405322	96490769	96490842
CR 2-40	405098	405318	405096	985167	405104	405323	96490769	96490842
CR 2-50	405098	405318	405096	985167	405105	405324	96490769	96490842
CR 2-60	405098	405318	405096	985167	405106	405325	96490769	96490842
CR 2-70	405098	405318	405096	985167	405107	405326	96490769	96490842
CR 2-90	405098	405318	405096	985167	405108	405327	96490769	96490842
CR 2-110	405099	405319	405096	985167	405109	405328	96490769	96490842
CR 2-130	405099	405319	405096	985167	405110	405329	96449808	96490848
CR 2-150	405099	405319	405096	985167	405111	405330	96449808	96490848
CR 2-180	405100	405319		985167	405112	405331	96483132	96490848
CR 2-220	405100	405320		985167	405113	405332	96483132	96490848
CR 2-260	405100	405320		985167	405114	405333	96483132	96490848
CRN 2-20	405130		405096	985167	405208		96490769	96490842
CRN 2-30	405130		405096	985167	405209		96490769	96490842
CRN 2-40	405130		405096	985167	405210		96490769	96490842
CRN 2-50	405130		405096	985167	405211		96490769	96490842
CRN 2-60	405130		405096	985167	405212		96490769	96490842
CRN 2-70	405130		405096	985167	405213		96490769	96490842
CRN 2-90	405130		405096	985167	405214		96490769	96490842
CRN 2-110	405131		405096	985167	405215		96490769	96490842
CRN 2-130	405158		405096	985167	405216		96483132	96490848
CRN 2-150	405158		405096	985167	405217		96483132	96490848
CRN 2-180	405158			985167	405218		96483132	96490848
CRN 2-220	405132			985167	405219		96483132	96490848
CRN 2-260	405132			985167	405220		96483132	96490848

### Recommended spare parts for tenders.

Number of pumps	Number of service kits	Number of shaft seal kits	Number of chamber stacks	Number of ND bearings	Number of DE bearings
1	1	1	1	1	1
2	1	1	1	2	2
3	2	2	2	3	3
4	2	2	2	4	4
5	2	2	2	5	5
6	3	3	3	6	6
7	3	3	3	7	7
8	3	3	3	8	8
9	3	3	3	9	9
10	3	3	3	10	10

### Example: Spare parts for 4 units CR 2-100 with BUBE shaft seal and ceramic intermediate bearings.

- 2 years of operating: 2 off service kits: 405098  
2 off shaft seal kits: 405096
- 5 years of operating: 2 off shaft seal kits: 405096  
2 off chamber stacks: 405106  
4 off ND motor bearings: 96490769  
4 off DE motor bearings: 96490842

## RECOMMENDED SPARE PARTS FOR 2 AND 5 YEARS' OPERATING TIME

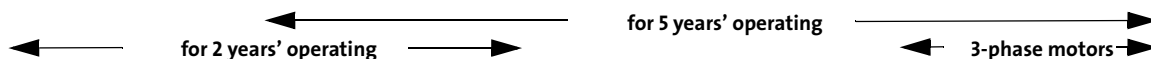

Type	Service kit ceramic	Service kit bronze	Shaft seal BUBE	Shaft seal AUUE/V	Chamber stack ceramic	Chamber stack bronze	ND-Motor bearing	DE-Motor bearing
CR 2-20	405098	405318	405096	985167	405102	405321	96490769	96490842
CR 2-30	405098	405318	405096	985167	405103	405322	96490769	96490842
CR 2-40	405098	405318	405096	985167	405104	405323	96490769	96490842
CR 2-50	405098	405318	405096	985167	405105	405324	96490769	96490842
CR 2-60	405098	405318	405096	985167	405106	405325	96490769	96490842
CR 2-70	405098	405318	405096	985167	405107	405326	96449808	96490848
CR 2-80	405098	405318	405096	985167	405115		96449808	96490848
CR 2-90	405098	405318	405096	985167	405108	405327	96483132	96490848
CR 2-100	405099	405319	405096	985167	405116		96483132	96490848
CR 2-110	405099	405319	405096	985167	405109	405328	96483132	96490848
CR 2-120	405099	405319		985167	405117		96483132	96490848
CR 2-130	405099	405319		985167	405110	405329	96483132	96457053
CR 2-150	405099	405319		985167	405111	405330	96483132	96457053
CR 2-180	405100	405320		985167	405112	405331	96490846	96467322
CRN 2-20	405130		405096	985167	405208		96490769	96490842
CRN 2-30	405130		405096	985167	405209		96490769	96490842
CRN 2-40	405130		405096	985167	405210		96490769	96490842
CRN 2-50	405130		405096	985167	405211		96490769	96490842
CRN 2-60	405130		405096	985167	405212		96490769	96490842
CRN 2-70	405130		405096	985167	405213		96449808	96490848
CRN 2-80	405130		405096	985167	405221		96449808	96490848
CRN 2-90	405130		405096	985167	405214		96483132	96490848
CRN 2-100	405131		405096	985167	405222		96483132	96490848
CRN 2-110	405131		405096	985167	405215		96483132	96490848
CRN 2-120	405131			985167	405223		96483132	96490848
CRN 2-130	405131			985167	405216		96483132	96457053
CRN 2-150	405131			985167	405217		96483132	96457053
CRN 2-180	405158			985167	405218		96490846	96467322

### Recommended spare parts for tenders.

Number of pumps	Number of service kits	Number of shaft seals	Number of chamber stacks	Number of ND bearings	Number of DE bearings
1	1	1	1	1	1
2	1	1	1	2	2
3	2	2	2	3	3
4	2	2	2	4	4
5	2	2	2	5	5
6	3	3	3	6	6
7	3	3	3	7	7
8	3	3	3	8	8
9	3	3	3	9	9
10	3	3	3	10	10

## RECOMMENDED SPARE PARTS FOR 2 AND 5 YEARS' OPERATING TIME

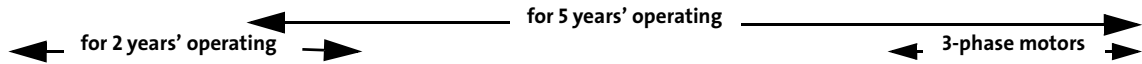

Type	Service kit ceramic	Service kit bronze	Shaft seal BUBE	Shaft seal AUUE/V	Chamber stack ceramic	Chamber stack bronze	ND-Motor bearing	DE-Motor bearing
CR 4-20/1	415286	515350	405096	985167	415254	415333	96490769	96490842
CR 4-20	415286	515350	405096	985167	415255	415334	96490769	96490842
CR 4-30	415286	515350	405096	985167	415256	415335	96490769	96490842
CR 4-40	415286	515350	405096	985167	415257	415336	96490769	96490842
CR 4-50	415286	515350	405096	985167	415258	415337	96490769	96490842
CR 4-60	415286	515350	405096	985167	415259	415338	96490769	96490842
CR 4-80/7	415287	415351	405096	985167	415260	415339	96483132	96490848
CR 4-80	415287	415351	405096	985167	415261	415340	96483132	96490848
CR 4-100	415287	415351	405096	985167	415262	415341	96483132	96490848
CR 4-120	415287	415351	405096	985167	415263	415342	96483132	96490848
CR 4-160/14	415349	415352	405096	985167	415264	415343	96483132	96457053
CR 4-160	415349	415352	405096	985167	415265	415344	96483132	96457053
CR 4-190	415288	415353		985167	415266	415345	96490846	96467322
CR 4-220	415288	415353		985167	415267	415346	96490846	96467322
CRN 4-20/1	415289		405096	985167	415268		96490769	96490842
CRN 4-20	415289		405096	985167	415269		96490769	96490842
CRN 4-30	415289		405096	985167	415270		96490769	96490842
CRN 4-40	415289		405096	985167	415271		96490769	96490842
CRN 4-50	415289		405096	985167	415272		96490769	96490842
CRN 4-60	415289		405096	985167	415273		96490769	96490842
CRN 4-80/7	415290		405096	985167	415274		96483132	96490848
CRN 4-80	415290		405096	985167	415275		96483132	96490848
CRN 4-100	415290		405096	985167	415276		96483132	96490848
CRN 4-120	415290		405096	985167	415277		96483132	96490848
CRN 4-160/14	415351		405096	985167	415278		96483132	96457053
CRN 4-160	415351		405096	985167	415279		96483132	96457053
CRN 4-190	415291			985167	415280		96490846	96467322
CRN 4-220	415291			985167	415281		96490846	96467322

### Recommended spare parts for tenders.

Number of pumps	Number of service kits	Number of shaft seal kits	Number of chamber stacks	Number of ND bearings	Number of DE bearings
1	1	1	1	1	1
2	1	1	1	2	2
3	2	2	2	3	3
4	2	2	2	4	4
5	2	2	2	5	5
6	3	3	3	6	6
7	3	3	3	7	7
8	3	3	3	8	8
9	3	3	3	9	9
10	3	3	3	10	10

### Example: Spare parts for 4 units CR 4-60 with BUBE shaft seal and ceramic intermediate bearings.

- 2 years of operating: 2 off service kits: 415286  
2 off shaft seal kits: 405096
- 5 years of operating: 2 off shaft seal kits: 405096  
2 off chamber stacks: 415259  
4 off ND motor bearings: 96490769  
4 off DE motor bearings: 96490842

## RECOMMENDED SPARE PARTS FOR 2 AND 5 YEARS' OPERATING TIME

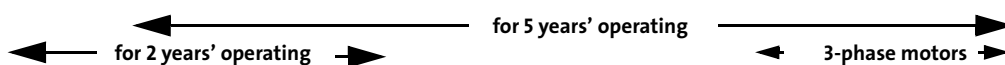

Type	Service kit	Shaft seal BUBE	Shaft seal AUUE/V	Chamber stack ceramic	Chamber stack bronze	ND-Motor bearing	DE-Motor bearing
CR 4-20/1	415286	405096	985167	415254	415333	96490769	96490842
CR 4-20	415286	405096	985167	415255	415334	96490769	96490842
CR 4-30	415286	405096	985167	415256	415335	96490769	96490842
CR 4-40	415286	405096	985167	415257	415336	96483132	96490848
CR 4-50	415286	405096	985167	415258	415337	96483132	96490848
CR 4-60	415286	405096	985167	415259	415338	96483132	96490848
CR 4-80/7	415287	405096	985167	415260	415339	96483132	96457053
CR 4-80	415287	405096	985167	415261	415340	96483132	96457053
CR 4-100	415287	405096	985167	415262	415341	96490846	96467322
CR 4-120	415287		985167	415263	415342	96490846	96467322
CR 4-160/14	415349		985167	415264	415343	96490846	96463976
CR 4-160	415349		985167	415265	415344	96490846	96463976
CRN 4-20/1	415289	405096	985167	415268		96490769	96490842
CRN 4-20	415289	405096	985167	415269		96490769	96490842
CRN 4-30	415289	405096	985167	415270		96490769	96490842
CRN 4-40	415289	405096	985167	415271		96483132	96490848
CRN 4-50	415289	405096	985167	415272		96483132	96490848
CRN 4-60	415289	405096	985167	415273		96483132	96490848
CRN 4-80/7	415290	405096	985167	415274		96483132	96457053
CRN 4-80	415290	405096	985167	415275		96483132	96457053
CRN 4-100	415290	405096	985167	415276		96490846	96467322
CRN 4-120	415290		985167	415277		96490846	96467322
CRN 4-160/14	415351		985167	415278		96490846	96463976
CRN 4-160	415351		985167	415279		96490846	96463976

### Recommended spare parts for tenders.

Number of pumps	Number of service kits	Number of shaft seal kits	Number of chamber stacks	Number of ND bearings	Number of DE bearings
1	1	1	1	1	1
2	1	1	1	2	2
3	2	2	2	3	3
4	2	2	2	4	4
5	2	2	2	5	5
6	3	3	3	6	6
7	3	3	3	7	7
8	3	3	3	8	8
9	3	3	3	9	9
10	3	3	3	10	10

## RECOMMENDED SPARE PARTS FOR 2 AND 5 YEARS' OPERATING TIME

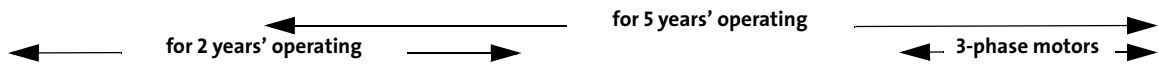

Type	Service kit ceramic	Service kit bronze	Shaft seal BUBE	Shaft seal AUUE/V	Chamber stack ceramic	Chamber stack bronze	ND-Motor bearing	DE-Motor bearing
CR 8-20/1	425066	425300	425062	985201	425049	425267	96490769	96490842
CR 8-20	425066	425300	425062	985201	425050	425268	96490769	96490842
CR 8-30	425066	425300	425062	985201	425051	425269	96490769	96490842
CR 8-40	425066	425300	425062	985201	425052	425270	96483132	96490848
CR 8-50	425066	425300	425062	985201	425053	425271	96483132	96490848
CR 8-60	425066	425300	425062	985201	425054	425272	96483132	96490848
CR 8-80	425067	425301	425062	985201	425055	425273	96483132	96490848
CR 8-100	425067	425301	425062	985201	425056	425274	96490846	96467322
CR 8-120	425067	425301	425062	985201	425057	425275	96490846	96467322
CR 8-140	425068	425302		985201	425058	425276	96490846	96463976
CR 8-160	425068	425302		985201	425059	425277	96490846	96463976
CR 8-180	425068	425302		985201	425060	425278	96490846	96463976
CR 8-200	425068	425302		985201	425061	425279	96490846	96463976
CRN 8-20/1	425069		425062	985204	425219		96490769	96490842
CRN 8-20	425069		425062	985204	425220		96490769	96490842
CRN 8-30	425069		425062	985204	425221		96490769	96490842
CRN 8-40	425069		425062	985204	425222		96483132	96490848
CRN 8-50	425069		425062	985204	425223		96483132	96490848
CRN 8-60	425069		425062	985204	425224		96483132	96490848
CRN 8-80	425070		425062	985204	425225		96483132	96490848
CRN 8-100	425070		425062	985204	425226		96490846	96467322
CRN 8-120	425070		425062	985204	425227		96490846	96467322
CRN 8-140	425266			985204	425228		96490846	96463976
CRN 8-160	425266			985204	425229		96490846	96463976
CRN 8-180	425266			985204	425230		96490846	96463976
CRN 8-200	425266			985204	425231		96490846	96463976

### Recommended spare parts for tenders.

Number of pumps	Number of service kits	Number of shaft seal kits	Number of chamber stacks	Number of ND bearings	Number of DE bearings
1	1	1	1	1	1
2	1	1	1	2	2
3	2	2	2	3	3
4	2	2	2	4	4
5	2	2	2	5	5
6	3	3	3	6	6
7	3	3	3	7	7
8	3	3	3	8	8
9	3	3	3	9	9
10	3	3	3	10	10

### Example: Spare parts for 4 units CR 8-60 with BUBE shaft seal and ceramic intermediate bearings.

- 2 years of operating: 2 off service kits: 425066  
2 off shaft seal kits: 425062
- 5 years of operating: 2 off shaft seal kits: 425062  
2 off chamber stacks: 425054  
4 off ND motor bearings: 96483132  
4 off DE motor bearings: 96490848

## RECOMMENDED SPARE PARTS FOR 2 AND 5 YEARS' OPERATING TIME

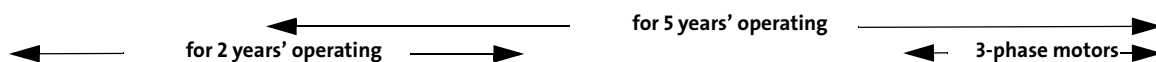

Type	Service kit ceramic	Service kit bronze	Shaft seal BUBE	Shaft seal AUUE/V	Chamber stack ceramic	Chamber stack bronze	ND-Motor bearing	DE-Motor bearing
CR 8-20/1	425066	425300	425062	985201	425049	425267	96490769	96490842
CR 8-20	425066	425300	425062	985201	425050	425268	96483132	96490848
CR 8-30	425066	425300	425062	985201	425051	425269	96483132	96490848
CR 8-40	425066	425300	425062	985201	425052	425270	96483132	96457053
CR 8-50	425066	425300	425062	985201	425053	425271	96483132	96457053
CR 8-60	425066	425300	425062	985201	425054	425272	96490846	96467322
CR 8-80	425067	425301	425062	985201	425055	425273	96490846	96463976
CR 8-100	425067	425301	425062	985201	425056	425274	96490846	96463976
CR 8-120	425067	425301	425062	985201	425057	425275	96490846	96463976
CR 8-140	425068	425302		985201	425058	425276	00ID3139	00ID0583
CR 8-160	425068	425302		985201	425059	425277	00ID3139	00ID0583
CRN 8-20/1	425069		425062	985204	425219		96490769	96490842
CRN 8-20	425069		425062	985204	425220		96483132	96490848
CRN 8-30	425069		425062	985204	425221		96483132	96490848
CRN 8-40	425069		425062	985204	425222		96483132	96457053
CRN 8-50	425069		425062	985204	425223		96483132	96457053
CRN 8-60	425069		425062	985204	425224		96490846	96467322
CRN 8-80	425070		425062	985204	425225		96490846	96463976
CRN 8-100	425070		425062	985204	425226		96490846	96463976
CRN 8-120	425070		425062	985204	425227		96490846	96463976
CRN 8-140	425266			985204	425228		00ID3139	00ID0583
CRN 8-160	425266			985204	425229		00ID3139	00ID0583

### Recommended spare parts for tenders.

Number of pumps	Number of service kits	Number of shaft seal kits	Number of chamber stacks	Number of ND bearings	Number of DE bearings
1	1	1	1	1	1
2	1	1	1	2	2
3	2	2	2	3	3
4	2	2	2	4	4
5	2	2	2	5	5
6	3	3	3	6	6
7	3	3	3	7	7
8	3	3	3	8	8
9	3	3	3	9	9
10	3	3	3	10	10

### Example: Spare parts for 4 units CR 8-60 with BUBE shaft seal and ceramic intermediate bearings.

- 2 years of operating: 2 off service kits: 425066  
2 off shaft seal kits: 425062
- 5 years of operating: 2 off shaft seal kits: 425062  
2 off chamber stacks: 425054  
4 off ND motor bearings: 96490846  
4 off DE motor bearings: 96467322

## RECOMMENDED SPARE PARTS FOR 2 AND 5 YEARS' OPERATING TIME

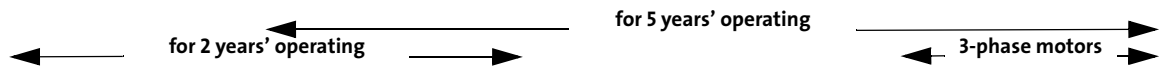

Type	Service kit ceramic	Service kit bronze	Shaft seal BUBE	Shaft seal AUUE/V	Chamber stack ceramic	Chamber stack bronze	ND-Motor bearing	DE-Motor bearing
CR 16-30/2	335078	335000	425062	985201	335065	335190	96483132	96490848
CR 16-30	335078	335000	425062	985201	335066	335191	96483132	96457053
CR 16-40	335078	335000	425062	985201	335067	335192	96490846	96467322
CR 16-50	335078	335000	425062	985201	335068	335193	96490846	96463976
CR 16-60	335078	335000	425062	985201	335069	335194	96490846	96463976
CR 16-70	335079	335001	425062	985201	335070	335195	96490846	96463976
CR 16-80	335079	335001	425062	985201	335071	335196	96490846	96463976
CR 16-100	335079	335001		985201	335072	335197	00ID3139	00ID0583
CR 16-120	335080	335002		985201	335073	335198	00ID3139	00ID0583
CR 16-140	335080	335002		985201	335074	335199	00ID6705	00ID0583
CR 16-160	335080	335002		985201	335075	335200	00ID6705	00ID0583
CRN 16-30/2	335081		425062	985204	335220		96483132	96490848
CRN 16-30	335081		425062	985204	335221		96483132	96457053
CRN 16-40	335081		425062	985204	335222		96490846	96467322
CRN 16-50	335081		425062	985204	335223		96490846	96463976
CRN 16-60	335081		425062	985204	335224		96490846	96463976
CRN 16-70	335082		425062	985204	335225		96490846	96463976
CRN 16-80	335126		425062	985204	335226		96490846	96463976
CRN 16-100	335126			985204	335227		00ID3139	00ID0583
CRN 16-120	335083			985204	335228		00ID3139	00ID0583
CRN 16-140	335083			985204	335229		00ID6705	00ID0583
CRN 16-160	335083			985204	335230		00ID6705	00ID0583

### Recommended spare parts for tenders.

Number of pumps	Number of service kits	Number of shaft seal kits	Number of chamber stacks	Number of ND bearings	Number of DE bearings
1	1	1	1	1	1
2	1	1	1	2	2
3	2	2	2	3	3
4	2	2	2	4	4
5	2	2	2	5	5
6	3	3	3	6	6
7	3	3	3	7	7
8	3	3	3	8	8
9	3	3	3	9	9
10	3	3	3	10	10

### Example: Spare parts for 4 units CR 16-60 with BUBE shaft seal and ceramic intermediate bearings.

- 2 years of operating: 2 off service kits: 335078  
2 off shaft seal kits: 425062
- 5 years of operating: 2 off shaft seal kits: 425062  
2 off chamber stacks: 335069  
4 off ND motor bearings: 96490846  
4 off DE motor bearings: 96463976

## RECOMMENDED SPARE PARTS FOR 2 AND 5 YEARS' OPERATING TIME

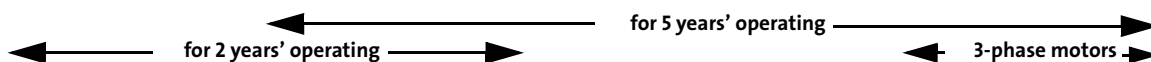

Type	Service kit ceramic	Service kit bronze	Shaft seal BUBE	Shaft seal AUUE/V	Chamber stack ceramic	Chamber stack bronze	ND-Motor bearing	DE-Motor bearing
CR 16-30/2	335078	335000	425062	985201	335065	335190	96483132	96457053
CR 16-30	335078	335000	425062	985201	335066	335191	96490846	96463976
CR 16-40	335078	335000	425062	985201	335067	335192	96490846	96463976
CR 16-50	335078	335000	425062	985201	335068	335193	96490846	96463976
CR 16-60	335078	335000	425062	985201	335069	335194	00ID3139	00ID0583
CR 16-70	335079	335001	425062	985201	335070	335195	00ID3139	00ID0583
CR 16-80	335079	335001		985201	335071	335196	00ID6705	00ID0583
CR 16-100	335079	335001		985201	335072	335197	00ID6705	00ID0583
CRN 16-30/2	335081		425062	985204	335220		96483132	96457053
CRN 16-30	335081		425062	985204	335221		96490846	96463976
CRN 16-40	335081		425062	985204	335222		96490846	96463976
CRN 16-50	335081		425062	985204	335223		96490846	96463976
CRN 16-60	335081		425062	985204	335224		00ID3139	00ID0583
CRN 16-70	335082		425062	985204	335225		00ID3139	00ID0583
CRN 16-80	335126			985204	335226		00ID6705	00ID0583
CRN 16-100	335126			985204	335227		00ID6705	00ID0583

### Recommended spare parts for tenders.

Number of pumps	Number of service kits	Number of shaft seal kits	Number of chamber stacks	Number of ND bearings	Number of DE bearings
1	1	1	1	1	1
2	1	1	1	2	2
3	2	2	2	3	3
4	2	2	2	4	4
5	2	2	2	5	5
6	3	3	3	6	6
7	3	3	3	7	7
8	3	3	3	8	8
9	3	3	3	9	9
10	3	3	3	10	10

### Example: Spare parts for 4 units CR 16-60 with BUBE shaft seal and ceramic intermediate bearings.

- 2 years of operating: 2 off service kits: 335078  
2 off shaft seal kits: 425062
- 5 years of operating: 2 off shaft seal kits: 425062  
2 off chamber stacks: 335069  
4 off ND motor bearings: 00ID3139  
4 off DE motor bearings: 00ID0583

RECOMMENDED SPARE PARTS FOR 2 AND 5 YEARS' OPERATING TIME

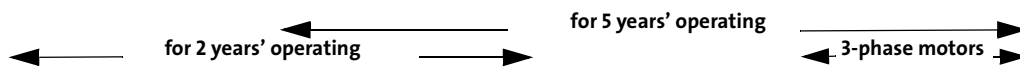

Type	Wear part kit	Intermediate bearing kit	Shaft seal kit	Gasket kit	Bottom bearing kit	Chamber stack	Motor bearings		Motor make
							ND-side	DE-side	
CR 32-1-1	96416728		Table 1	Table 2	96416580	96416273	96483132	96490848	Grundfos
CR 32-1	96416728				96416580	96416274	96483132	96490848	
CR 32-2-2	96416728				96416580	96416905	96483132	96457053	
CR 32-2	96416728				96416580	96416276	96490846	96467322	
CR 32-3-2	96416729	96416574			96416580	96416906	96490846	96463976	
CR 32-3	96416729	96416574			96416580	96416277	96490846	96463976	
CR 32-4-2	96416729	96416574			96416580	96416907	96490846	96463976	
CR 32-4	96416729	96416574			96416580	96416278	96490846	96463976	
CR 32-5-2	96416729	96416574			96416580	96416908	00ID3139	00ID0583	
CR 32-5	96416729	96416574			96416580	96416279	00ID3139	00ID0583	
CR 32-6-2	96416729	96416574			96416580	96416909	00ID3139	00ID0583	
CR 32-6	96416729	96416574			96416580	96416280	00ID3139	00ID0583	
CR 32-7-2	96416729	96416574			96416580	96416910	00ID6705	00ID0583	
CR 32-7	96416729	96416574			96416580	96416281	00ID6705	00ID0583	
CR 32-8-2	96416730	96416576			96416580	96416911	00ID6705	00ID0583	
CR 32-8	96416730	96416576			96416580	96416282	00ID6705	00ID0583	
CR 32-9-2	96416730	96416576			96416580	96416912	00ID6705	00ID0583	
CR 32-9	96416730	96416576			96416580	96416283	00ID6705	00ID0583	
CR 32-10-2	96416730	96416576			96416580	96416913	00ID6705	00ID0583	
CR 32-10	96416730	96416576			96416580	96416284	00ID6705	00ID0583	
CR 32-11-2	96416730	96416576			96416580	96416914	00ID6705	00ID0583	
CR 32-11	96416730	96416576			96416580	96416285	00ID6705	00ID0583	
CR 32-12-2	96416731	96416576			96416580	96416915	00ID6705	00ID0583	
CR 32-12	96416731	96416576			96416580	96416286	00ID6705	00ID0583	
CR 32-13-2	96416731	96416576			96416580	96416916	00ID6719	00ID0375	
CR 32-13	96416731	96416576			96416580	96416287	00ID6719	00ID0375	
CR 32-14-2	96416731	96416576			96416580	96416917	00ID6719	00ID0375	
CR 32-14	96416731	96416576			96416580	96416288	00ID6719	00ID0375	

Table 1	Shaft seal type	EUHE	EUHV	EUBE	EUBV	EUUE	EUUV	HUBE	HUBV	EQQE	EQQV
	Part number	96416582	96416583	96416584	96416585	96416586	96416587	96417021	96417022	96440029	96440030

	Shaft seal type	HQQV	HQBV	HQQE	HQBE
	Part number	96525490	96525459	96525458	96525457

Table 2	Gasket kit type	EPDM	FKM
	Part number	96416597	96416598

Recommended spare parts for tenders.

Number of pumps	Wear part kits	Intermediate bearing kit	Shaft seal kits	Gasket kit	Bottom bearing kit	Chamber stacks	Motor bearing	
							ND-side	DE-side
1	1	1	1	1	1	1	1	1
2	1	1	1	1	1	1	2	2
3	2	2	2	2	2	2	3	3
4	2	2	2	2	2	2	4	4
5	2	2	2	2	2	2	5	5
6	3	3	3	3	3	3	6	6
7	3	3	3	3	3	3	7	7
8	3	3	3	3	3	3	8	8
9	3	3	3	3	3	3	9	9
10	3	3	3	3	3	3	10	10

Example: Spare parts for 4 units CR 32-6 with EUBE shaft seal and EPDM gaskets.

2 years of operating:

- 2 off wear part kits: 96416729
- 2 off intermediate bearing kits: 96416574
- 2 off shaft seal kits: 96416584
- 2 off gasket kits: 96416597

5 years of operating:

- 2 off shaft seal kits: 96416584
- 2 off gasket kits: 96416597
- 2 off bottom bearing kit: 96416580

- 2 off chamber stacks: 96416280
- 4 off ND motor bearings: 00ID3139
- 4 off DE motor bearings: 00ID0583

RECOMMENDED SPARE PARTS FOR 2 AND 5 YEARS' OPERATING TIME



Type	Wear part kit	Intermediate bearing kit	Shaft seal kit	Gasket kit	Bottom bearing kit	Chamber stack	Motor bearings		Motor make
							ND-side	DE-side	
CR 32-1-1	96416728		Table 1	Table 2	96416580	96416273	96483132	96490848	Grundfos
CR 32-1	96416728				96416580	96416274	96483132	96457053	
CR 32-2-2	96416728				96416580	96416905	96490846	96463976	
CR 32-2-1	96416728				96416580	96416275	96490846	96463976	
CR 32-2	96416728				96416580	96416276	96490846	96463976	
CR 32-3-2	96416729	96416574			96416580	96416906	00ID3139	00ID0583	
CR 32-3	96416729	96416574			96416580	96416277	00ID3139	00ID0583	
CR 32-4-2	96416729	96416574			96416580	96416907	00ID3139	00ID0583	
CR 32-4	96416729	96416574			96416580	96416278	00ID6705	00ID0583	
CR 32-5-2	96416729	96416574			96416580	96416908	00ID6705	00ID0583	
CR 32-5	96416729	96416574			96416580	96416279	00ID6705	00ID0583	
CR 32-6-2	96416729	96416574			96416580	96416909	00ID6705	00ID0583	
CR 32-6	96416729	96416574			96416580	96416280	00ID6705	00ID0583	
CR 32-7-2	96416729	96416574			96416580	96416910	00ID6705	00ID0583	
CR 32-7	96416729	96416574			96416580	96416281	00ID6705	00ID0583	
CR 32-8-2	96416730	96416576			96416580	96416911	00ID6719	00ID0375	
CR 32-8	96416730	96416576			96416580	96416282	00ID6719	00ID0375	
CR 32-9-2	96416730	96416576			96416580	96416912	00ID6719	00ID0375	
CR 32-9	96416730	96416576			96416580	96416283	00ID6719	00ID0375	
CR 32-10-2	96416730	96416576			96416580	96416913	00ID6719	00ID0375	
CR 32-10	96416730	96416576	96416580	96416284	00ID6719	00ID0375			
CR 32-11-2	96416730	96416576	96416580	96416914	00ID6719	00ID0375			

Table 1	Shaft seal type	EUHE	EUHV	EUBE	EUBV	EUUE	EUUV	HUBE	HUBV	EQQE	EQQV
	Part number	96416582	96416583	96416584	96416585	96416586	96416587	96417021	96417022	96440029	96440030

	Shaft seal type	HQQV	HQBV	HQQE	HQBE
	Part number	96525490	96525459	96525458	96525457

Table 2	Gasket kit type	EPDM	FKM
	Part number	96416597	96416598

Recommended spare parts for tenders.

Number of pumps	Wear part kit	Intermediate bearing kit	Shaft seal kit	Gasket kit	Bottom bearing kit	Chamber stack	Motor bearing	
							ND-side	DE-side
1	1	1	1	1	1	1	1	1
2	1	1	1	1	1	1	2	2
3	2	2	2	2	2	2	3	3
4	2	2	2	2	2	2	4	4
5	2	2	2	2	2	2	5	5
6	3	3	3	3	3	3	6	6
7	3	3	3	3	3	3	7	7
8	3	3	3	3	3	3	8	8
9	3	3	3	3	3	3	9	9
10	3	3	3	3	3	3	10	10

Example: Spare parts for 4 units CR 32-6 with EUBE shaft seal and EPDM gaskets.

2 years of operating:

- 2 off wear part kits: 96416729
- 2 off intermediate bearing kits: 96416574
- 2 off shaft seal kits: 96416584
- 2 off gasket kits: 96416597

5 years of operating:

- 2 off shaft seal kits: 96416584
- 2 off gasket kits: 96416597
- 2 off bottom bearing kit: 96416580
- 2 off chamber stacks: 96416280
- 4 off ND motor bearings: 00ID6705
- 4 off DE motor bearings: 00ID0583

RECOMMENDED SPARE PARTS FOR 2 AND 5 YEARS' OPERATING TIME

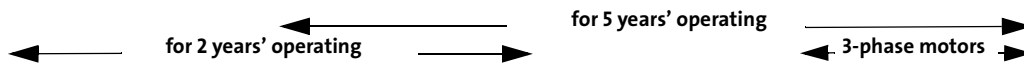

Type	Wear part kit	Intermediate bearing kit	Shaft seal kit	Gasket kit	Bottom bearing kit	Chamber stack	Motor bearings		Motor make
							ND-side	DE-side	
CRN 32-1-1	96416728		Table 1	Table 2	96416580	96416290	96483132	96490848	Grundfos
CRN 32-1	96416728				96416580	96416291	96483132	96490848	
CRN 32-2-2	96416728				96416580	96416918	96483132	96457053	
CRN 32-2	96416728				96416580	96416293	96490846	96467322	
CRN 32-3-2	96416729	96416574			96416580	96416919	96490846	96463976	
CRN 32-3	96416729	96416574			96416580	96416294	96490846	96463976	
CRN 32-4-2	96416729	96416574			96416580	96416920	96490846	96463976	
CRN 32-4	96416729	96416574			96416580	96416295	96490846	96463976	
CRN 32-5-2	96416729	96416574			96416580	96416921	00ID3139	00ID0583	
CRN 32-5	96416729	96416574			96416580	96416296	00ID3139	00ID0583	
CRN 32-6-2	96416729	96416574			96416580	96416922	00ID3139	00ID0583	
CRN 32-6	96416729	96416574			96416580	96416297	00ID3139	00ID0583	
CRN 32-7-2	96416729	96416574			96416580	96416923	00ID6705	00ID0583	
CRN 32-7	96416729	96416574			96416580	96416298	00ID6705	00ID0583	
CRN 32-8-2	96416730	96416576			96416580	96416924	00ID6705	00ID0583	
CRN 32-8	96416730	96416576			96416580	96416299	00ID6705	00ID0583	
CRN 32-9-2	96416730	96416576			96416580	96416925	00ID6705	00ID0583	
CRN 32-9	96416730	96416576			96416580	96416300	00ID6705	00ID0583	
CRN 32-10-2	96416730	96416576			96416580	96416926	00ID6705	00ID0583	
CRN 32-10	96416730	96416576			96416580	96416301	00ID6705	00ID0583	
CRN 32-11-2	96416730	96416576			96416580	96416927	00ID6705	00ID0583	
CRN 32-11	96416730	96416576			96416580	96416302	00ID6705	00ID0583	
CRN 32-12-2	96416731	96416576			96416580	96416928	00ID6705	00ID0583	
CRN 32-12	96416731	96416576			96416580	96416303	00ID6705	00ID0583	
CRN 32-13-2	96416731	96416576			96416580	96416929	00ID6719	00ID0375	
CRN 32-13	96416731	96416576			96416580	96416304	00ID6719	00ID0375	
CRN 32-14-2	96416731	96416576			96416580	96416930	00ID6719	00ID0375	
CRN 32-14	96416731	96416576			96416580	96416305	00ID6719	00ID0375	

Table 1	Shaft seal type	EUHE	EUHV	EUBE	EUBV	EUUE	EUUV	HUBE	HUBV	EQQE	EQQV
	Part number	96416582	96416583	96416584	96416585	96416586	96416587	96417021	96417022	96440029	96440030

	Shaft seal type	HQQV	HQBV	HQQE	HQBE
	Part number	96525490	96525459	96525458	96525457

Table 2	Gasket kit type	EPDM	FKM
	Part number	96416597	96416598

Recommended spare parts for tenders.

Number of pumps	Wear part kits	Intermediate bearing kit	Shaft seal kits	Gasket kit	Bottom bearing kit	Chamber stacks	Motor bearing	
							ND-side	DE-side
1	1	1	1	1	1	1	1	1
2	1	1	1	1	1	1	2	2
3	2	2	2	2	2	2	3	3
4	2	2	2	2	2	2	4	4
5	2	2	2	2	2	2	5	5
6	3	3	3	3	3	3	6	6
7	3	3	3	3	3	3	7	7
8	3	3	3	3	3	3	8	8
9	3	3	3	3	3	3	9	9
10	3	3	3	3	3	3	10	10

Example: Spare parts for 4 units CRN 32-6 with EUBE shaft seal and EPDM gaskets.

2 years of operating:

- 2 off wear part kits: 96416729
- 2 off intermediate bearing kits: 96416574
- 2 off shaft seal kits: 96416584
- 2 off gasket kits: 96416597

5 years of operating:

- 2 off shaft seal kits: 96416584
- 2 off gasket kits: 96416597
- 2 off bottom bearing kit: 96416580

- 2 off chamber stacks: 96416297
- 4 off ND motor bearings: 00ID3139
- 4 off DE motor bearings: 00ID0583

## RECOMMENDED SPARE PARTS FOR 2 AND 5 YEARS' OPERATING TIME



Type	Wear part kit	Intermediate bearing kit	Shaft seal kit	Gasket kit	Bottom bearing kit	Chamber stack	Motor bearings		Motor make
							ND-side	DE-side	
CRN 32-1-1	96416728		Table 1	Table 2	96416580	96416290	96483132	96490848	Grundfos
CRN 32-1	96416728				96416580	96416291	96483132	96457053	
CRN 32-2-2	96416728				96416580	96416918	96490846	96463976	
CRN 32-2-1	96416728				96416580	96416992	96490846	96463976	
CRN 32-2	96416728				96416580	96416293	96490846	96463976	
CRN 32-3-2	96416729	96416574			96416580	96416919	00ID3139	00ID0583	
CRN 32-3	96416729	96416574			96416580	96416294	00ID3139	00ID0583	
CRN 32-4-2	96416729	96416574			96416580	96416920	00ID3139	00ID0583	
CRN 32-4	96416729	96416574			96416580	96416295	00ID6705	00ID0583	
CRN 32-5-2	96416729	96416574			96416580	96416921	00ID6705	00ID0583	
CRN 32-5	96416729	96416574			96416580	96416296	00ID6705	00ID0583	
CRN 32-6-2	96416729	96416574			96416580	96416922	00ID6705	00ID0583	
CRN 32-6	96416729	96416574			96416580	96416297	00ID6705	00ID0583	
CRN 32-7-2	96416729	96416574			96416580	96416923	00ID6705	00ID0583	
CRN 32-7	96416729	96416574			96416580	96416298	00ID6705	00ID0583	
CRN 32-8-2	96416730	96416576			96416580	96416924	00ID6719	00ID0375	
CRN 32-8	96416730	96416576			96416580	96416299	00ID6719	00ID0375	
CRN 32-9-2	96416730	96416576			96416580	96416925	00ID6719	00ID0375	
CRN 32-9	96416730	96416576			96416580	96416300	00ID6719	00ID0375	
CRN 32-10-2	96416730	96416576			96416580	96416926	00ID6719	00ID0375	
CRN 32-10	96416730	96416576	96416580	96416301	00ID6719	00ID0375			
CRN 32-11-2	96416730	96416576	96416580	96416927	00ID6719	00ID0375			

Table 1	Shaft seal type	EUHE	EUHV	EUBE	EUBV	EUUE	EUUV	HUBE	HUBV	EQQE	EQQV
	Part number	96416582	96416583	96416584	96416585	96416586	96416587	96417021	96417022	96440029	96440030

	Shaft seal type	HQQV	HQBV	HQQE	HQBE
	Part number	96525490	96525459	96525458	96525457

Table 2	Gasket kit type	EPDM	FKM
	Part number	96416597	96416598

Recommended spare parts for tenders.

Number of pumps	Wear part kits	Intermediate bearing kit	Shaft seal kits	Gasket kit	Bottom bearing kit	Chamber stacks	Motor bearing	
							ND-side	DE-side
1	1	1	1	1	1	1	1	1
2	1	1	1	1	1	1	2	2
3	2	2	2	2	2	2	3	3
4	2	2	2	2	2	2	4	4
5	2	2	2	2	2	2	5	5
6	3	3	3	3	3	3	6	6
7	3	3	3	3	3	3	7	7
8	3	3	3	3	3	3	8	8
9	3	3	3	3	3	3	9	9
10	3	3	3	3	3	3	10	10

Example: Spare parts for 4 units CRN 32-6 with EUBE shaft seal and EPDM gaskets.

**2 years of operating:**

- 2 off wear part kits: 96416729
- 2 off intermediate bearing kits: 96416574
- 2 off shaft seal kits: 96416584
- 2 off gasket kits: 96416597

**5 years of operating:**

- 2 off shaft seal kits: 96416584
- 2 off gasket kits: 96416597
- 2 off bottom bearing kit: 96416580
- 2 off chamber stacks: 96416297
- 4 off ND motor bearings: 00ID6705
- 4 off DE motor bearings: 00ID0583

RECOMMENDED SPARE PARTS FOR 2 AND 5 YEARS' OPERATING TIME



Type	Wear part kit	Intermediate bearing kit	Shaft seal kit	Gasket kit	Bottom bearing kit	Chamber stack	Motor bearings		Motor make
							ND-side	DE-side	
CR 45-1-1	96416732		Table 1	Table 2	96416580	96416222	96483132	96457053	Grundfos
CR 45-1	96416732				96416580	96416223	96490846	96467322	
CR 45-2-2	96416732				96416580	96416224	96490846	96463976	
CR 45-2	96416732				96416580	96416226	96490846	96463976	
CR 45-3-2	96416733	96416577			96416580	96416227	00ID3139	00ID0583	
CR 45-3	96416733	96416577			96416580	96416228	00ID3139	00ID0583	
CR 45-4-2	96416733	96416577			96416580	96416229	00ID6705	00ID0583	
CR 45-4	96416733	96416577			96416580	96416230	00ID6705	00ID0583	
CR 45-5-2	96416733	96416577			96416580	96416934	00ID6705	00ID0583	
CR 45-5	96416733	96416577			96416580	96416232	00ID6705	00ID0583	
CR 45-6-2	96416733	96416577			96416580	96416233	00ID6705	00ID0583	
CR 45-6	96416733	96416577			96416580	96416234	00ID6705	00ID0583	
CR 45-7-2	96416733	96416577			96416580	96416935	00ID6719	00ID0375	
CR 45-7	96416733	96416577			96416580	96416235	00ID6719	00ID0375	
CR 45-8-2	96416734	96416578			96416580	96416936	00ID6719	00ID0375	
CR 45-8	96416734	96416578			96416580	96416236	00ID6719	00ID0375	
CR 45-9-2	96416734	96416578	96416580	96416237	00ID6719	00ID0375			
CR 45-9	96416734	96416578	96416580	96416937	00ID6719	00ID0375			
CR 45-10-2	96416734	96416578	96416580	96416938	00ID6719	00ID0375			
CR 45-10	96416734	96416578	96416580	96416238	00ID6719	00ID0375			

Table 1	Shaft seal type	EUHE	EUHV	EUBE	EUBV	EUUE	EUUV	HUBE	HUBV	EQQE	EQQV
	Part number	96416582	96416583	96416584	96416585	96416586	96416587	96417021	96417022	96440029	96440030

	Shaft seal type	HQQV	HQBV	HQQE	HQBE
	Part number	96525490	96525459	96525458	96525457

Table 2	Gasket kit type	EPDM	FKM
	Part number	96416599	96416600

Recommended spare parts for tenders.

Number of pumps	Wear part kits	Intermediate bearing kit	Shaft seal kits	Gasket kit	Bottom bearing kit	Chamber stacks	Motor bearing	
							ND-side	DE-side
1	1	1	1	1	1	1	1	1
2	1	1	1	1	1	1	2	2
3	2	2	2	2	2	2	3	3
4	2	2	2	2	2	2	4	4
5	2	2	2	2	2	2	5	5
6	3	3	3	3	3	3	6	6
7	3	3	3	3	3	3	7	7
8	3	3	3	3	3	3	8	8
9	3	3	3	3	3	3	9	9
10	3	3	3	3	3	3	10	10

Example: Spare parts for 4 units CR 45-6 with EUBE shaft seal and EPDM gaskets.

2 years of operating:  
 2 off wear part kits: 96416733  
 2 off intermediate bearing kits: 96416577  
 2 off shaft seal kits: 96416584  
 2 off gasket kits: 96416599

5 years of operating:  
 2 off shaft seal kits: 96416584  
 2 off gasket kits: 96416599  
 2 off bottom bearing kit: 96416580  
 2 off chamber stacks: 96416230  
 4 off ND motor bearings: 00ID6705  
 4 off DE motor bearings: 00ID0583

## RECOMMENDED SPARE PARTS FOR 2 AND 5 YEARS' OPERATING TIME

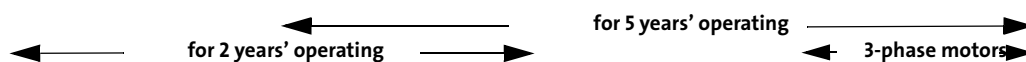

Type	Wear part kit	Intermediate bearing kit	Shaft seal kit	Gasket kit	Bottom bearing kit	Chamber stack	Motor bearings		Motor make
							ND-side	DE-side	
CR 45-1-1	96416732		Table 1	Table 2	96416580	96416222	96490846	96463976	Grundfos
CR 45-1	96416732				96416580	96416223	96490846	96463976	
CR 45-2-2	96416732				96416580	96416224	96490846	96463976	
CR 45-2-1	96416732				96416580	96416225	96490846	96463976	
CR 45-2	96416732				96416580	96416226	00ID6705	00ID0583	Siemens
CR 45-3-2	96416733	96416577			96416580	96416227	00ID6705	00ID0583	
CR 45-3-1	96416733	96416577			96416580	96416932	00ID6705	00ID0583	
CR 45-3	96416733	96416577			96416580	96416228	00ID6705	00ID0583	
CR 45-4-2	96416733	96416577			96416580	96416229	00ID6705	00ID0583	
CR 45-4-1	96416733	96416577			96416580	96416933	00ID6719	00ID0375	
CR 45-4	96416733	96416577			96416580	96416230	00ID6719	00ID0375	
CR 45-5-2	96416733	96416577			96416580	96416934	00ID6719	00ID0375	
CR 45-5-1	96416733	96416577			96416580	96416231	00ID6719	00ID0375	
CR 45-5	96416733	96416577			96416580	96416232	00ID6719	00ID0375	
CR 45-6-2	96416733	96416577			96416580	96416233	00ID6719	00ID0375	
CR 45-6	96416733	96416577			96416580	96416234	00ID6719	00ID0375	
CR 45-7-2	96416733	96416577	96416580	96416935	00ID6719	00ID0375			

Table 1	Shaft seal type	EUHE	EUHV	EUBE	EUBV	EUUE	EUUV	HUBE	HUBV	EQQE	EQQV
	Part number	96416582	96416583	96416584	96416585	96416586	96416587	96417021	96417022	96440029	96440030

	Shaft seal type	HQQV	HQBV	HQQE	HQBE
	Part number	96525490	96525459	96525458	96525457

Table 2	Gasket kit type	EPDM	FKM
	Part number	96416599	96416600

Recommended spare parts for tenders.

Number of pumps	Wear part kits	Intermediate bearing kit	Shaft seal kits	Gasket kit	Bottom bearing kit	Chamber stacks	Motor bearing	
							ND-side	DE-side
1	1	1	1	1	1	1	1	1
2	1	1	1	1	1	1	2	2
3	2	2	2	2	2	2	3	3
4	2	2	2	2	2	2	4	4
5	2	2	2	2	2	2	5	5
6	3	3	3	3	3	3	6	6
7	3	3	3	3	3	3	7	7
8	3	3	3	3	3	3	8	8
9	3	3	3	3	3	3	9	9
10	3	3	3	3	3	3	10	10

Example: Spare parts for 4 units CR 45-6 with EUBE shaft seal and EPDM gaskets.

**2 years of operating:**

- 2 off wear part kits: 96416733
- 2 off intermediate bearing kits: 96416577
- 2 off shaft seal kits: 96416584
- 2 off gasket kits: 96416599

**5 years of operating:**

- 2 off shaft seal kits: 96416584
- 2 off gasket kits: 96416599
- 2 off bottom bearing kit: 96416580
- 2 off chamber stacks: 96416234
- 4 off ND motor bearings: 00ID6719
- 4 off DE motor bearings: 00ID0375

RECOMMENDED SPARE PARTS FOR 2 AND 5 YEARS' OPERATING TIME



Type	Wear part kit	Intermediate bearing kit	Shaft seal kit	Gasket kit	Bottom bearing kit	Chamber stack	Motor bearings		Motor make
							ND-side	DE-side	
CRN 45-1-1	96416732		Table 1	Table 2	96416580	96416239	96483132	96457053	Grundfos
CRN 45-1	96416732				96416580	96416240	96490846	96467322	
CRN 45-2-2	96416732				96416580	96416241	96490846	96463976	
CRN 45-2	96416732				96416580	96416243	96490846	96463976	
CRN 45-3-2	96416733	96416577			96416580	96416244	00ID3139	00ID0583	
CRN 45-3	96416733	96416577			96416580	96416245	00ID3139	00ID0583	
CRN 45-4-2	96416733	96416577			96416580	96416246	00ID6705	00ID0583	
CRN 45-4	96416733	96416577			96416580	96416247	00ID6705	00ID0583	
CRN 45-5-2	96416733	96416577			96416580	96416941	00ID6705	00ID0583	
CRN 45-5	96416733	96416577			96416580	96416249	00ID6705	00ID0583	
CRN 45-6-2	96416733	96416577			96416580	96416250	00ID6705	00ID0583	
CRN 45-6	96416733	96416577			96416580	96416251	00ID6705	00ID0583	
CRN 45-7-2	96416733	96416577			96416580	96416942	00ID6719	00ID0375	
CRN 45-7	96416733	96416577			96416580	96416252	00ID6719	00ID0375	
CRN 45-8-2	96416734	96416578			96416580	96416943	00ID6719	00ID0375	
CRN 45-8	96416734	96416578			96416580	96416253	00ID6719	00ID0375	
CRN 45-9-2	96416734	96416578			96416580	96416254	00ID6719	00ID0375	
CRN 45-9	96416734	96416578			96416580	96416944	00ID6719	00ID0375	
CRN 45-10-2	96416734	96416578			96416580	96416945	00ID6719	00ID0375	
CRN 45-10	96416734	96416578			96416580	96416255	00ID6719	00ID0375	

Table 1	Shaft seal type	EUHE	EUHV	EUBE	EUBV	EUUE	EUUV	HUBE	HUBV	EQQE	EQQV
	Part number	96416582	96416583	96416584	96416585	96416586	96416587	96417021	96417022	96440029	96440030

	Shaft seal type	HQQV	HQBV	HQQE	HQBE
	Part number	96525490	96525459	96525458	96525457

Table 2	Gasket kit type	EPDM	FKM
	Part number	96416599	96416600

Recommended spare parts for tenders.

Number of pumps	Wear part kits	Intermediate bearing kit	Shaft seal kits	Gasket kit	Bottom bearing kit	Chamber stacks	Motor bearing	
							ND-side	DE-side
1	1	1	1	1	1	1	1	1
2	1	1	1	1	1	1	2	2
3	2	2	2	2	2	2	3	3
4	2	2	2	2	2	2	4	4
5	2	2	2	2	2	2	5	5
6	3	3	3	3	3	3	6	6
7	3	3	3	3	3	3	7	7
8	3	3	3	3	3	3	8	8
9	3	3	3	3	3	3	9	9
10	3	3	3	3	3	3	10	10

Example: Spare parts for 4 units CRN 45-6 with EUBE shaft seal and EPDM gaskets.

2 years of operating:

- 2 off wear part kits: 96416733
- 2 off intermediate bearing kits: 96416577
- 2 off shaft seal kits: 96416584
- 2 off gasket kits: 96416599

5 years of operating:

- 2 off shaft seal kits: 96416584
- 2 off gasket kits: 96416599
- 2 off bottom bearing kit: 96416580
- 2 off chamber stacks: 96416251
- 4 off ND motor bearings: 00ID6705
- 4 off DE motor bearings: 00ID0583

## RECOMMENDED SPARE PARTS FOR 2 AND 5 YEARS' OPERATING TIME

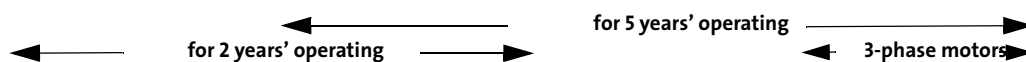

Type	Wear part kit	Intermediate bearing kit	Shaft seal kit	Gasket kit	Bottom bearing kit	Chamber stack	Motor bearings		Motor make
							ND-side	DE-side	
CRN 45-1-1	96416732		Table 1	Table 2	96416580	96416239	96490846	96463976	Grundfos
CRN 45-1	96416732				96416580	96416240	96490846	96463976	
CRN 45-2-2	96416732				96416580	96416241	96490846	96463976	
CRN 45-2-1	96416732				96416580	96416242	96490846	96463976	
CRN 45-2	96416732				96416580	96416243	00ID6705	00ID0583	Siemens
CRN 45-3-2	96416733	96416577			96416580	96416244	00ID6705	00ID0583	
CRN 45-3-1	96416733	96416577			96416580	96416939	00ID6705	00ID0583	
CRN 45-3	96416733	96416577			96416580	96416245	00ID6705	00ID0583	
CRN 45-4-2	96416733	96416577			96416580	96416246	00ID6705	00ID0583	
CRN 45-4-1	96416733	96416577			96416580	96416940	00ID6719	00ID0375	
CRN 45-4	96416733	96416577			96416580	96416247	00ID6719	00ID0375	
CRN 45-5-2	96416733	96416577			96416580	96416941	00ID6719	00ID0375	
CRN 45-5-1	96416733	96416577			96416580	96416248	00ID6719	00ID0375	
CRN 45-5	96416733	96416577			96416580	96416249	00ID6719	00ID0375	
CRN 45-6-2	96416733	96416577			96416580	96416250	00ID6719	00ID0375	
CRN 45-6	96416733	96416577			96416580	96416251	00ID6719	00ID0375	
CRN 45-7-2	96416733	96416577	96416580	96416942	00ID6719	00ID0375			

Table 1	Shaft seal type	EUHE	EUHV	EUBE	EUBV	EUUE	EUUV	HUBE	HUBV	EQQE	EQQV
	Part number	96416582	96416583	96416584	96416585	96416586	96416587	96417021	96417022	96440029	96440030

	Shaft seal type	HQQV	HQBV	HQQE	HQBE
	Part number	96525490	96525459	96525458	96525457

Table 2	Gasket kit type	EPDM	FKM
	Part number	96416599	96416600

Recommended spare parts for tenders.

Number of pumps	Wear part kits	Intermediate bearing kit	Shaft seal kits	Gasket kit	Bottom bearing kit	Chamber stacks	Motor bearing	
							ND-side	DE-side
1	1	1	1	1	1	1	1	1
2	1	1	1	1	1	1	2	2
3	2	2	2	2	2	2	3	3
4	2	2	2	2	2	2	4	4
5	2	2	2	2	2	2	5	5
6	3	3	3	3	3	3	6	6
7	3	3	3	3	3	3	7	7
8	3	3	3	3	3	3	8	8
9	3	3	3	3	3	3	9	9
10	3	3	3	3	3	3	10	10

Example: Spare parts for 4 units CRN 45-6 with EUBE shaft seal and EPDM gaskets.

**2 years of operating:**

- 2 off wear part kits: 96416733
- 2 off intermediate bearing kits: 96416577
- 2 off shaft seal kits: 96416584
- 2 off gasket kits: 96416599

**5 years of operating:**

- 2 off shaft seal kits: 96416584
- 2 off gasket kits: 96416599
- 2 off bottom bearing kit: 96416580
- 2 off chamber stacks: 96416234
- 4 off ND motor bearings: 00ID6719
- 4 off DE motor bearings: 00ID0375

RECOMMENDED SPARE PARTS FOR 2 AND 5 YEARS' OPERATING TIME



Type	Wear part kit	Intermediate bearing kit	Shaft seal kit	Gasket kit	Bottom bearing kit	Chamber stack	Motor bearings		Motor make
							ND-side	DE-side	
CR 64-1-1	96416735		Table 1	Table 2	96416580	96416307	96490846	96467322	Grundfos
CR 64-1	96416735				96416580	96416308	96490846	96463976	
CR 64-2-2	96416735				96416580	96416309	96490846	96463976	
CR 64-2-1	96416735				96416580	96416310	00ID3139	00ID0583	
CR 64-2	96416735				96416580	96416311	00ID3139	00ID0583	Siemens
CR 64-3-2	96416736	96416573			96416580	96416312	00ID6705	00ID0583	
CR 64-3-1	96416736	96416573			96416580	96416313	00ID6705	00ID0583	
CR 64-3	96416736	96416573			96416580	96416314	00ID6705	00ID0583	
CR 64-4-2	96416736	96416573			96416580	96416315	00ID6705	00ID0583	
CR 64-4-1	96416736	96416573			96416580	96416316	00ID6705	00ID0583	
CR 64-4	96416736	96416573			96416580	96416317	00ID6705	00ID0583	
CR 64-5-2	96416736	96416573			96416580	96416318	00ID6719	00ID0375	
CR 64-5-1	96416736	96416573			96416580	96416319	00ID6719	00ID0375	
CR 64-5	96416736	96416573			96416580	96416320	00ID6719	00ID0375	
CR 64-6-2	96416736	96416573	96416580	96416321	00ID6719	00ID0375			
CR 64-6-1	96416736	96416573	96416580	96416322	00ID6719	00ID0375			
CR 64-6	96416736	96416573	96416580	96416323	00ID6719	00ID0375			
CR 64-7-2	96416736	96416573	96416580	96416324	00ID6719	00ID0375			
CR 64-7-1	96416736	96416573	96416580	96416325	00ID6719	00ID0375			

Table 1	Shaft seal type	EUHE	EUHV	EUBE	EUBV	EUUE	EUUV	HUBE	HUBV	EQQE	EQQV
	Part number	96416582	96416583	96416584	96416585	96416586	96416587	96417021	96417022	96440029	96440030

	Shaft seal type	HQQV	HQBV	HQQE	HQBE
	Part number	96525490	96525459	96525458	96525457

Table 2	Gasket kit type	EPDM	FKM
	Part number	96416599	96416600

Recommended spare parts for tenders.

Number of pumps	Wear part kits	Intermediate bearing kit	Shaft seal kits	Gasket kit	Bottom bearing kit	Chamber stacks	Motor bearing	
							ND-side	DE-side
1	1	1	1	1	1	1	1	1
2	1	1	1	1	1	1	2	2
3	2	2	2	2	2	2	3	3
4	2	2	2	2	2	2	4	4
5	2	2	2	2	2	2	5	5
6	3	3	3	3	3	3	6	6
7	3	3	3	3	3	3	7	7
8	3	3	3	3	3	3	8	8
9	3	3	3	3	3	3	9	9
10	3	3	3	3	3	3	10	10

Example: Spare parts for 4 units CR 64-2 with EUBE shaft seal and EPDM gaskets.

2 years of operating:

- 2 off wear part kits: 96416735
- 2 off shaft seal kits: 96416584
- 2 off gasket kits: 96416599

5 years of operating:

- 2 off shaft seal kits: 96416584
- 2 off gasket kits: 96416599
- 2 off bottom bearing kit: 96416580
- 2 off chamber stacks: 96416311
- 4 off ND motor bearings: 00ID3139
- 4 off DE motor bearings: 00ID0583

## RECOMMENDED SPARE PARTS FOR 2 AND 5 YEARS' OPERATING TIME



Type	Wear part kit	Intermediate bearing kit	Shaft seal kit	Gasket kit	Bottom bearing kit	Chamber stack	Motor bearings		Motor make
							ND-side	DE-side	
CR 64-1-1	96416735		Table 1	Table 2	96416580	96416307	96490846	96463976	Grundfos
CR 64-1	96416735				96416580	96416308	00ID3139	00ID0583	
CR 64-2-2	96416735				96416580	96416309	00ID6705	00ID0583	
CR 64-2-1	96416735				96416580	96416310	00ID6705	00ID0583	Siemens
CR 64-2	96416735				96416580	96416311	00ID6705	00ID0583	
CR 64-3-2	96416736	96416573			96416580	96416312	00ID6719	00ID0375	
CR 64-3-1	96416736	96416573			96416580	96416313	00ID6719	00ID0375	
CR 64-3	96416736	96416573			96416580	96416314	00ID6719	00ID0375	
CR 64-4-2	96416736	96416573			96416580	96416315	00ID6719	00ID0375	
CR 64-4-1	96416736	96416573			96416580	96416316	00ID6719	00ID0375	
CR 64-4	96416736	96416573	96416580	96416317	00ID6719	00ID0375			

Table 1	Shaft seal type	EUHE	EUHV	EUBE	EUBV	EUUE	EUUV	HUBE	HUBV	EQQE	EQQV
	Part number	96416582	96416583	96416584	96416585	96416586	96416587	96417021	96417022	96440029	96440030

	Shaft seal type	HQQV	HQBV	HQQE	HQBE
	Part number	96525490	96525459	96525458	96525457

Table 2	Gasket kit type	EPDM	FKM
	Part number	96416599	96416600

Recommended spare parts for tenders.

Number of pumps	Wear part kits	Intermediate bearing kit	Shaft seal kits	Gasket kit	Bottom bearing kit	Chamber stacks	Motor bearing	
							ND-side	DE-side
1	1	1	1	1	1	1	1	1
2	1	1	1	1	1	1	2	2
3	2	2	2	2	2	2	3	3
4	2	2	2	2	2	2	4	4
5	2	2	2	2	2	2	5	5
6	3	3	3	3	3	3	6	6
7	3	3	3	3	3	3	7	7
8	3	3	3	3	3	3	8	8
9	3	3	3	3	3	3	9	9
10	3	3	3	3	3	3	10	10

Example: Spare parts for 4 units CR 64-2 with EUBE shaft seal and EPDM gaskets.

**2 years of operating:**

- 2 off wear part kits: 96416735
- 2 off shaft seal kits: 96416584
- 2 off gasket kits: 96416599

**5 years of operating:**

- 2 off shaft seal kits: 96416584
- 2 off gasket kits: 96416599
- 2 off bottom bearing kit: 96416580
- 2 off chamber stacks: 96416311
- 4 off ND motor bearings: 00ID3139
- 4 off DE motor bearings: 00ID0583

RECOMMENDED SPARE PARTS FOR 2 AND 5 YEARS' OPERATING TIME

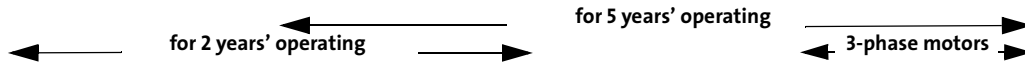

Type	Wear part kit	Intermediate bearing kit	Shaft seal kit	Gasket kit	Bottom bearing kit	Chamber stack	Motor bearings		Motor make
							ND-side	DE-side	
CRN 64-1-1	96416735		Table 1	Table 2	96416580	96416326	96490846	96467322	Grundfos
CRN 64-1	96416735				96416580	96416327	96490846	96463976	
CRN 64-2-2	96416735				96416580	96416328	96490846	96463976	
CRN 64-2-1	96416735				96416580	96416329	00ID3139	00ID0583	
CRN 64-2	96416735				96416580	96416330	00ID3139	00ID0583	
CRN 64-3-2	96416736	96416573			96416580	96416331	00ID6705	00ID0583	Siemens
CRN 64-3-1	96416736	96416573			96416580	96416332	00ID6705	00ID0583	
CRN 64-3	96416736	96416573			96416580	96416333	00ID6705	00ID0583	
CRN 64-4-2	96416736	96416573			96416580	96416334	00ID6705	00ID0583	
CRN 64-4-1	96416736	96416573			96416580	96416335	00ID6705	00ID0583	
CRN 64-4	96416736	96416573			96416580	96416336	00ID6705	00ID0583	
CRN 64-5-2	96416736	96416573			96416580	96416337	00ID6719	00ID0375	
CRN 64-5-1	96416736	96416573			96416580	96416338	00ID6719	00ID0375	
CRN 64-5	96416736	96416573			96416580	96416339	00ID6719	00ID0375	
CRN 64-6-2	96416736	96416573			96416580	96416340	00ID6719	00ID0375	
CRN 64-6-1	96416736	96416573			96416580	96416341	00ID6719	00ID0375	
CRN 64-6	96416736	96416573			96416580	96416342	00ID6719	00ID0375	
CRN 64-7-2	96416736	96416573	96416580	96416343	00ID6719	00ID0375			
CRN 64-7-1	96416736	96416573	96416580	96416344	00ID6719	00ID0375			

Table 1	Shaft seal type	EUHE	EUHV	EUBE	EUBV	EUUE	EUUV	HUBE	HUBV	EQQE	EQQV
	Part number	96416582	96416583	96416584	96416585	96416586	96416587	96417021	96417022	96440029	96440030

	Shaft seal type	HQQV	HQBV	HQQE	HQBE
	Part number	96525490	96525459	96525458	96525457

Table 2	Gasket kit type	EPDM	FKM
	Part number	96416599	96416600

Recommended spare parts for tenders.

Number of pumps	Wear part kits	Intermediate bearing kit	Shaft seal kits	Gasket kit	Bottom bearing kit	Chamber stacks	Motor bearing	
							ND-side	DE-side
1	1	1	1	1	1	1	1	1
2	1	1	1	1	1	1	2	2
3	2	2	2	2	2	2	3	3
4	2	2	2	2	2	2	4	4
5	2	2	2	2	2	2	5	5
6	3	3	3	3	3	3	6	6
7	3	3	3	3	3	3	7	7
8	3	3	3	3	3	3	8	8
9	3	3	3	3	3	3	9	9
10	3	3	3	3	3	3	10	10

Example: Spare parts for 4 units CRN 64-2 with EUBE shaft seal and EPDM gaskets.

2 years of operating:

- 2 off wear part kits: 96416735
- 2 off shaft seal kits: 96416584
- 2 off gasket kits: 96416599

5 years of operating:

- 2 off shaft seal kits: 96416584
- 2 off gasket kits: 96416599
- 2 off bottom bearing kit : 96416580
- 2 off chamber stacks: 96416330
- 4 off ND motor bearings: 00ID3139
- 4 off DE motor bearings: 00ID0583

## RECOMMENDED SPARE PARTS FOR 2 AND 5 YEARS' OPERATING TIME



Type	Wear part kit	Intermediate bearing kit	Shaft seal kit	Gasket kit	Bottom bearing kit	Chamber stack	Motor bearings		Motor make
							ND-side	DE-side	
CRN 64-1-1	96416735		Table 1	Table 2	96416580	96416326	96490846	96463976	Grundfos
CRN 64-1	96416735				96416580	96416327	00ID3139	00ID0583	
CRN 64-2-2	96416735				96416580	96416328	00ID6705	00ID0583	Siemens
CRN 64-2-1	96416735				96416580	96416329	00ID6705	00ID0583	
CRN 64-2	96416735				96416580	96416330	00ID6705	00ID0583	
CRN 64-3-2	96416736	96416573			96416580	96416331	00ID6719	00ID0375	
CRN 64-3-1	96416736	96416573			96416580	96416332	00ID6719	00ID0375	
CRN 64-3	96416736	96416573			96416580	96416333	00ID6719	00ID0375	
CRN 64-4-2	96416736	96416573			96416580	96416334	00ID6719	00ID0375	
CRN 64-4-1	96416736	96416573			96416580	96416335	00ID6719	00ID0375	
CRN 64-4	96416736	96416573			96416580	96416336	00ID6719	00ID0375	

Table 1	Shaft seal type	EUHE	EUHV	EUBE	EUBV	EUUE	EUUV	HUBE	HUBV	EQQE	EQQV
	Part number	96416582	96416583	96416584	96416585	96416586	96416587	96417021	96417022	96440029	96440030

	Shaft seal type	HQQV	HQBV	HQQE	HQBE
	Part number	96525490	96525459	96525458	96525457

Table 2	Gasket kit type	EPDM	FKM
	Part number	96416599	96416600

Recommended spare parts for tenders.

Number of pumps	Wear part kits	Intermediate bearing kit	Shaft seal kits	Gasket kit	Bottom bearing kit	Chamber stacks	Motor bearing	
							ND-side	DE-side
1	1	1	1	1	1	1	1	1
2	1	1	1	1	1	1	2	2
3	2	2	2	2	2	2	3	3
4	2	2	2	2	2	2	4	4
5	2	2	2	2	2	2	5	5
6	3	3	3	3	3	3	6	6
7	3	3	3	3	3	3	7	7
8	3	3	3	3	3	3	8	8
9	3	3	3	3	3	3	9	9
10	3	3	3	3	3	3	10	10

Example: Spare parts for 4 units CRN 64-2 with EUBE shaft seal and EPDM gaskets.

**2 years of operating:**

- 2 off wear part kits: 96416735
- 2 off shaft seal kits: 96416584
- 2 off gasket kits: 96416599

**5 years of operating:**

- 2 off shaft seal kits: 96416584
- 2 off gasket kits: 96416599
- 2 off bottom bearing kit: 96416580
- 2 off chamber stacks: 96416330
- 4 off ND motor bearings: 00ID6705
- 4 off DE motor bearings: 00ID0583

**RECOMMENDED SPARE PARTS FOR 2 AND 5 YEARS' OPERATING TIME**



Type	Wear part kit	Intermediate bearing kit	Shaft seal kit	Gasket kit	Bottom bearing kit	Chamber stack	Motor bearings		Motor make
							ND-side	DE-side	
CR 90-1-1	96416737		Table 1	Table 2	96416580	96416256	96490846	96463976	Grundfos
CR 90-1	96416737				96416580	96416257	96490846	96463976	
CR 90-2-2	96416737				96416580	96416258	00ID3139	00ID0583	
CR 90-2	96416737				96416580	96416260	00ID6705	00ID0583	
CR 90-3-2	96416738	96416579			96416580	96416261	00ID6705	00ID0583	Siemens
CR 90-3	96416738	96416579			96416580	96416263	00ID6705	00ID0583	
CR 90-4-2	96416738	96416579			96416580	96416264	00ID6719	00ID0375	
CR 90-4	96416738	96416579			96416580	96416266	00ID6719	00ID0375	
CR 90-5-2	96416738	96416579			96416580	96416267	00ID6719	00ID0375	
CR 90-5	96416738	96416579			96416580	96416269	00ID6719	00ID0375	
CR 90-6-2	96416738	96416579	96416580	96416270	00ID6714	00ID6717			
CR 90-6	96416738	96416579	96416580	96416272	00ID6714	00ID6717			

Table 1	Shaft seal type	EUHE	EUHV	EUBE	EUBV	EUUE	EUUV	HUBE	HUBV	EQQE	EQQV
	Part number	96416582	96416583	96416584	96416585	96416586	96416587	96417021	96417022	96440029	96440030

	Shaft seal type	HQQV	HQBV	HQQE	HQBE
	Part number	96525490	96525459	96525458	96525457

Table 2	Gasket kit type	EPDM	FKM
	Part number	96416601	96416602

Recommended spare parts for tenders.

Number of pumps	Wear part kits	Intermediate bearing kit	Shaft seal kits	Gasket kit	Bottom bearing kit	Chamber stacks	Motor bearing	
							ND-side	DE-side
1	1	1	1	1	1	1	1	1
2	1	1	1	1	1	1	2	2
3	2	2	2	2	2	2	3	3
4	2	2	2	2	2	2	4	4
5	2	2	2	2	2	2	5	5
6	3	3	3	3	3	3	6	6
7	3	3	3	3	3	3	7	7
8	3	3	3	3	3	3	8	8
9	3	3	3	3	3	3	9	9
10	3	3	3	3	3	3	10	10

Example: Spare parts for 4 units CR 90-2 with EUBE shaft seal and EPDM gaskets.

2 years of operating:

- 2 off wear part kits: 96416737
- 2 off shaft seal kits: 96416584
- 2 off gasket kits: 96416601

5 years of operating:

- 2 off shaft seal kits: 96416584
- 2 off gasket kits: 96416601
- 2 off bottom bearing kit: 96416580
- 2 off chamber stacks: 96416260
- 4 off ND motor bearings: 00ID6705
- 4 off DE motor bearings: 00ID0583

## RECOMMENDED SPARE PARTS FOR 2 AND 5 YEARS' OPERATING TIME

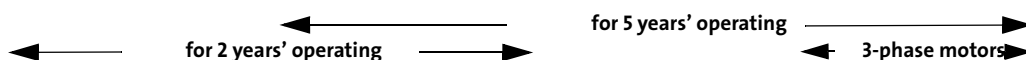

Type	Wear part kit	Intermediate bearing kit	Shaft seal kit	Gasket kit	Bottom bearing kit	Chamber stack	Motor bearings		Motor make
							ND-side	DE-side	
CR 90-1-1	96416737		Table 1	Table 2	96416580	96416256	00ID3139	00ID0583	Grundfos
CR 90-1	96416737				96416580	96416257	00ID6705	00ID0583	Siemens
CR 90-2-2	96416737				96416580	96416258	00ID6705	00ID0583	
CR 90-2-1	96416737				96416580	96416259	00ID6705	00ID0583	
CR 90-2	96416737				96416580	96416260	00ID6719	00ID0375	
CR 90-3-2	96416738	96416579			96416580	96416261	00ID6719	00ID0375	
CR 90-3-1	96416738	96416579			96416580	96416262	00ID6719	00ID0375	
CR 90-3	96416738	96416579			96416580	96416263	00ID6714	00ID6717	
CR 90-4-2	96416738	96416579			96416580	96416264	00ID6714	00ID6717	
CR 90-4-1	96416738	96416579			96416580	96416265	00ID6714	00ID6717	

Table 1	Shaft seal type	EUHE	EUHV	EUBE	EUBV	EUUE	EUUV	HUBE	HUBV	EQQE	EQQV
	Part number	96416582	96416583	96416584	96416585	96416586	96416587	96417021	96417022	96440029	96440030

	Shaft seal type	HQQV	HQBV	HQQE	HQBE
	Part number	96525490	96525459	96525458	96525457

Table 2	Gasket kit type	EPDM	FKM
	Part number	96416601	96416602

Recommended spare parts for tenders.

Number of pumps	Wear part kits	Intermediate bearing kit	Shaft seal kits	Gasket kit	Bottom bearing kit	Chamber stacks	Motor bearing	
							ND-side	DE-side
1	1	1	1	1	1	1	1	1
2	1	1	1	1	1	1	2	2
3	2	2	2	2	2	2	3	3
4	2	2	2	2	2	2	4	4
5	2	2	2	2	2	2	5	5
6	3	3	3	3	3	3	6	6
7	3	3	3	3	3	3	7	7
8	3	3	3	3	3	3	8	8
9	3	3	3	3	3	3	9	9
10	3	3	3	3	3	3	10	10

Example: Spare parts for 4 units CR 90-2 with EUBE shaft seal and EPDM gaskets.

**2 years of operating:**

- 2 off wear part kits: 96416737
- 2 off shaft seal kits: 96416584
- 2 off gasket kits: 96416601

**5 years of operating:**

- 2 off shaft seal kits: 96416584
- 2 off gasket kits: 96416601
- 2 off bottom bearing kit: 96416580
- 2 off chamber stacks: 96416260
- 4 off ND motor bearings: 00ID6719
- 4 off DE motor bearings: 00ID0375

RECOMMENDED SPARE PARTS FOR 2 AND 5 YEARS' OPERATING TIME

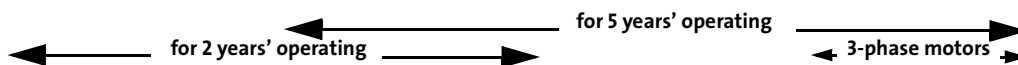

Type	Wear part kit	Intermediate bearing kit	Shaft seal kit	Gasket kit	Bottom bearing kit	Chamber stack	Motor bearings		Motor make		
							ND-side	DE-side			
CR 90-1-1	96416737		Table 1	Table 2	96416580	96458124	96490846	96463976	Grundfos		
CR 90-1	96416737				96416580	96458125	96490846	96463976			
CR 90-2-2	96416737				96416580	96458126	00ID3139	00ID0583			
CR 90-2	96416737				96416580	96458128	00ID6705	00ID0583			
CR 90-3-2	96416738	96416579			Table 1	Table 2	96416580	96458129	00ID6705	00ID0583	Siemens
CR 90-3	96416738	96416579					96416580	96458131	00ID6705	00ID0583	
CR 90-4-2	96416738	96416579					96416580	96458132	00ID6719	00ID0375	
CR 90-4	96416738	96416579					96416580	96458134	00ID6719	00ID0375	
CR 90-5-2	96416738	96416579					96416580	96458135	00ID6719	00ID0375	
CR 90-5	96416738	96416579					96416580	96458136	00ID6719	00ID0375	
CR 90-6-2	96416738	96416579					96416580	96458137	00ID6714	00ID6717	
CR 90-6	96416738	96416579					96416580	96458138	00ID6714	00ID6717	

Table 1	Shaft seal type	EUHE	EUHV	EUBE	EUBV	EUUE	EUUV	HUBE	HUBV	EQQE	EQQV
	Part number	96416582	96416583	96416584	96416585	96416586	96416587	96417021	96417022	96440029	96440030

	Shaft seal type	HQQV	HQBV	HQQE	HQBE
	Part number	96525490	96525459	96525458	96525457

Table 2	Gasket kit type	EPDM	FKM
	Part number	96416601	96416602

Recommended spare parts for tenders.

Number of pumps	Wear part kits	Intermediate bearing kit	Shaft seal kits	Gasket kit	Bottom bearing kit	Chamber stacks	Motor bearing	
							ND-side	DE-side
1	1	1	1	1	1	1	1	1
2	1	1	1	1	1	1	2	2
3	2	2	2	2	2	2	3	3
4	2	2	2	2	2	2	4	4
5	2	2	2	2	2	2	5	5
6	3	3	3	3	3	3	6	6
7	3	3	3	3	3	3	7	7
8	3	3	3	3	3	3	8	8
9	3	3	3	3	3	3	9	9
10	3	3	3	3	3	3	10	10

Example: Spare parts for 4 units CRN 90-2 with EUBE shaft seal and EPDM gaskets.

**2 years of operating:**  
 2 off wear part kits: 96416737  
 2 off shaft seal kits: 96416584  
 2 off gasket kits: 96416601

**5 years of operating:**  
 2 off shaft seal kits: 96416584  
 2 off gasket kits: 96416601  
 2 off bottom bearing kit: 96416580  
 2 off chamber stacks: 96448128  
 4 off ND motor bearings: 00ID6705  
 4 off DE motor bearings: 00ID0583

## RECOMMENDED SPARE PARTS FOR 2 AND 5 YEARS' OPERATING TIME

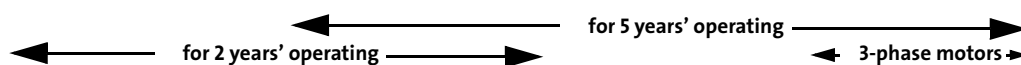

Type	Wear part kit	Intermediate bearing kit	Shaft seal kit	Gasket kit	Bottom bearing kit	Chamber stack	Motor bearings		Motor make
							ND-side	DE-side	
CR 90-1-1	96416737		Table 1	Table 2	96416580	96458124	00ID3139	00ID0583	Grundfos
CR 90-1	96416737				96416580	96458125	00ID6705	00ID0583	Siemens
CR 90-2-2	96416737				96416580	96458126	00ID6705	00ID0583	
CR 90-2-1	96416737				96416580	96458127	00ID6705	00ID0583	
CR 90-2	96416737				96416580	96458128	00ID6719	00ID0375	
CR 90-3-2	96416738	96416579			96416580	96458129	00ID6719	00ID0375	
CR 90-3-1	96416738	96416579			96416580	96458130	00ID6719	00ID0375	
CR 90-3	96416738	96416579			96416580	96458131	00ID6714	00ID6717	
CR 90-4-2	96416738	96416579			96416580	96458132	00ID6714	00ID6717	
CR 90-4-1	96416738	96416579			96416580	96458133	00ID6714	00ID6717	

Table 1	Shaft seal type	EUHE	EUHV	EUBE	EUBV	EUUE	EUUV	HUBE	HUBV	EQQE	EQQV
	Part number	96416582	96416583	96416584	96416585	96416586	96416587	96417021	96417022	96440029	96440030

	Shaft seal type	HQQV	HQBV	HQQE	HQBE
	Part number	96525490	96525459	96525458	96525457

Table 2	Gasket kit type	EPDM	FKM
	Part number	96416601	96416602

Recommended spare parts for tenders.

Number of pumps	Wear part kits	Intermediate bearing kit	Shaft seal kits	Gasket kit	Bottom bearing kit	Chamber stacks	Motor bearing	
							ND-side	DE-side
1	1	1	1	1	1	1	1	1
2	1	1	1	1	1	1	2	2
3	2	2	2	2	2	2	3	3
4	2	2	2	2	2	2	4	4
5	2	2	2	2	2	2	5	5
6	3	3	3	3	3	3	6	6
7	3	3	3	3	3	3	7	7
8	3	3	3	3	3	3	8	8
9	3	3	3	3	3	3	9	9
10	3	3	3	3	3	3	10	10

Example: Spare parts for 4 units CRN 90-2 with EUBE shaft seal and EPDM gaskets.

**2 years of operating:**

- 2 off wear part kits: 96416737
- 2 off shaft seal kits: 96416584
- 2 off gasket kits: 96416601

**5 years of operating:**

- 2 off shaft seal kits: 96416584
- 2 off gasket kits: 96416601
- 2 off bottom bearing kit: 96416580
- 2 off chamber stacks: 96458125
- 4 off ND motor bearings: 00ID6719
- 4 off DE motor bearings: 00ID0375

**RECOMMENDED SPARE PARTS FOR 2 AND 5 YEARS' OPERATING TIME**

NK Type	for 2 years operating		for 5 years operating																						
	4-poled motor [kW]	2-poled motor [kW]	Casket kit EPDM No 2	Casket kit FKM No 3																					
32 - 125	0.37	(-) 0.55	96432543	96432572	See table 1	No 8	No 8.1	Rubber bushings for Standard coupling	96029498	96428978	Nut, key and thrower kit No 9	96029520	Impeller GG 25 No.4	96029387	Impeller Bronze No.5	Shaft AISI 420 No.7	96029461	Bearing kit for bracket No.1	96029238	Motor bearing MMG model C DE	ID6728	96490842	96490842	Motor bearing MMG model C ND	ID6728
	(-) 0.75 - 1.1	(-) 1.5																							
	(-) 1.5	(-) 2.2																							
	(-) 2.2	(-) 4																							
32 - 160	0.37	(-) 0.75 - 1.1	96432544	96432573	See table 1	No 8	No 8.1	Rubber bushings for Standard coupling	96029498	96428978	96029520	96029351	96029388	96029387	96029461	96029238	96421472	96421472	96421472	96421472	96421472	96421472	96421472	96421472	
	(-) 0.55 - 0.75	(-) 1.5																							
	(-) 1.5	(-) 2.2																							
	(-) 2.2	(-) 4																							
32 - 200	0.37	(-) 0.55	96432545	96432574	See table 1	No 8	No 8.1	Rubber bushings for Standard coupling	96029498	96428978	96029520	96029352	96029389	96029461	96029238	96421472	96421472	96421472	96421472	96421472	96421472	96421472	96421472	96421472	
	0.55 - 0.75	(-) 1.1																							
	(-) 1.1	(-) 3																							
	(-) 3	(-) 4																							

The part number of the impeller is the impeller with max. diameter. Inform about the actual diameter when ordering.

**TABLE 1**

Shaft seal	Part no.	Stuffing box	Part no.
AQAV	96433665	SNE	96029222
AQOV	96433669	SNO	96029223
AQOE	96433673	SNF	96029224
DQOE	96433681	SKO	96029225
DQOV	96433685	Sleeve with gasket + O-ring	96029599
GQOE	96433689		
GQOV	96433693		
BAQE	96029201		
DAQF	96505023		
BQOE	96422157		
BOQV	96029205		
BAQV	96029207		
AQAE	96029569		

Number of pumps	Number of kit no 2 - 3	Number of shaft seal kits	Number of Stuffing box + shaft sleeve	Number of rubber bush.	Number of kit no 9	Number of kit no. 4-5	Number of kit no. 7	Number of kit no. 1	Number of motor-bearings
1	1	1	1	1	1	1	1	1	1
2	1	1	1	1	1	1	1	2	2
3	2	2	2	2	2	2	2	3	3
4	2	2	2	2	2	2	2	4	4
5	2	2	2	2	2	2	2	5	5
6	3	3	3	3	3	3	3	6	6
7	3	3	3	3	3	3	3	7	7
8	3	3	3	3	3	3	3	8	8
9	3	3	3	3	3	3	3	9	9
10	3	3	3	3	3	3	3	10	10

## RECOMMENDED SPARE PARTS FOR 2 AND 5 YEARS' OPERATING TIME

for 5 years operating

for 2 years operating

NK Type	4-poled motor [kW]	2-poled motor [kW]	Gasket kit EPDM No 2	Gasket kit FKM No 3	Shaft seal kit or stuffing box kit	Neck ring No 8	Neck ring No 8.1	Rubber bushings for Standard coupling	Rubber bushings for Spacer coupling	Nut, key and thrower kit No 9	Impeller * GG 25 No 4	Impeller * Bronze No 5	Shaft AISI 420 No. 7	Bearing kit for bracket No 1	Motor bearing MMG model C DE	Motor bearing MMG model C ND
40 - 125	(-) 0.37	(-) 0.75 - 1.1	96432543	96432572	See table 1	96427833		96029498	96428978	96029520	96029353	96029390	96029461	96029238	ID6728	ID6828
	(-) 1.5	(-) 2.2					96029499	96029499							96490842	96490842
	(-) 3						96029500	96029498	96428978	96029520	96029354	96029391	96029461	96029238	ID6730	ID6730
	(-) 4						96029501	96029498	96428978	96029520					ID6732	ID6732
40 - 160	(-) 0.37	(-) 0.55 - 0.75	96432544	96432573	See table 1	96427833		96029498	96428978	96029520	96029355	96029392	96029461	96029238	ID6728	ID6828
	(-) 1.1	(-) 1.5					96029499	96029499							96490842	96490842
	(-) 3	(-) 4					96029501	96029498	96428978	96029520					ID6730	ID6730
	(-) 5.5 - 7.5						96029501 *	96029498	96428978	96029520					ID6732	ID6732
40 - 200	(-) 0.55 - 0.75	(-) 1.1 - 1.5	96432545	96432574	See table 1	96427833		96029498	96428978	96029520	96029360	96029393	96029461	96029238	ID6730	ID6730
	(-) 1.5	(-) 2.2 - 3					96029499	96029499							ID6732	ID6732
	(-) 3	(-) 4					96029501	96029498	96428978	96029520					96421472	96421472
	(-) 5.5 - 7.5						96029501	96029498	96428978	96029520					96421473	96421473
40 - 250	(-) 0.75	(-) 1.1 - 1.5	96432547	96432576	See table 1	96427833		96029498	96428978	96029520	96029360	96029393	96029461	96029238	ID6730	ID6730
	(-) 1.5	(-) 2.2 - 3					96029499	96029499							ID6732	ID6732
	(-) 3	(-) 4					96029501	96029498	96428978	96029520					96421473	96421473
	(-) 5.5 - 7.5	(-) 11.0 - 15.0					96029501	96029498	96428978	96029520					ID6705	ID6705
40 - 250	(-) 18.5	(-) 22					96029502	96428980						ID6703	ID6703	

\* The part number of the impeller is the impeller with max. diameter. Inform about the actual diameter when ordering.

TABLE 1

Number of pumps	Number of kit no 2 - 3	Number of shaft seal kits	Number of Stuffing box + shaft sleeve	Number of kit no 8-8.1	Number of rubber bush.	Number of kit no 9	Number of kit no. 4-5	Number of kit no. 7	Number of kit no. 1	Number of motor-bearings
1	1	1	1	1	1	1	1	1	1	1
2	1	1	1	1	1	1	1	1	2	2
3	2	2	2	2	2	2	2	2	3	3
4	2	2	2	2	2	2	2	2	4	4
5	2	2	2	2	2	2	2	2	5	5
6	3	3	3	3	3	3	3	3	6	6
7	3	3	3	3	3	3	3	3	7	7
8	3	3	3	3	3	3	3	3	8	8
9	3	3	3	3	3	3	3	3	9	9
10	3	3	3	3	3	3	3	3	10	10

Shaft seal	Part no.	Stuffing box	Part no.
AQAV	96433665	SNE	96029222
AQOV	96433669	SNO	96029223
AQOE	96433673	SNF	96029224
DQOE	96433681	SKO	96029225
DQOV	96433685		
GQOE	96433689	Sleeve with gasket + O-ring	96029599
GQOV	96433693		
BAQE	96029201		
DAQF	96505023		
BQOE	96422157		
BQOV	96029205		
BAQV	96029207		
AQAE	96029569		

**RECOMMENDED SPARE PARTS FOR 2 AND 5 YEARS' OPERATING TIME**



NK Type	4-poled motor [kW]	2-poled motor [kW]	Gasket kit EPDM No 2	Gasket kit FKM No 3	Shaft seal kit or stuffing box kit	Neck ring No 8	Neck ring No 8.1	Rubber bushings for standard coupling	Rubber bushings for spacer coupling	Nut, key and thrower kit No 9	Impeller * GG 25 No 4	Impeller * Bronze No 5	Shaft AISI 420 No. 7	Bearing kit for bracket No 1	Motor bearing MMG model C DE	Motor bearing MMG model C ND
50 - 125	0.37	(-)	96432543	96432572	See table 1	96427835	No 8.1	96029498	96428978	96029520	96029357	96029394	96029461	96029238	ID6728	ID6828
	0.55 - 0.75	(-)													96490842	96490842
	(-)	1.5						96029499							ID6730	ID6730
	(-)	2.2						96029500							ID6732	ID6732
	(-)	3						96029501							96421472	96421472
50 - 160	(-)	4						96029501	96428979						96421473	96421473
	(-)	5.5 - 7.5	96432544	96432573	See table 1	96427835		96029501	96428978	96029520	96029358	96029395	96029461	96029238	96490842	96490842
	0.55 - 0.75	(-)						96029499							ID6730	ID6730
	1.1	(-)						96029500							ID6732	ID6732
	(-)	3						96029501							96421472	96421472
50 - 200	(-)	4						96029501	96428979						96421473	96421473
	(-)	5.5 - 7.5	96432545	96432574	See table 1	96427835		96029501	96428978	96029520	96029359	96029396	96029461	96029238	96490842	96490842
	(-)	11.0 - 15.0						96029499							ID6730	ID6730
	(-)	18.5						96029500							ID6732	ID6732
	(-)	22						96029501							96421473	96421473
50 - 250	(-)	18.5						96029502							ID6705	ID6705
	(-)	22						96029503	96428981						ID6703	ID6703
	1.1	(-)	96432547	96432576	See table 1	96427834		96029502		96029520	96029360	96029397	96029461	96029238	ID6703	ID6703
	1.5	(-)						96029500							ID6732	ID6732
	(-)	4						96029501	96428979						96421473	96421473

\* The part number of the impeller is the impeller with max. diameter. Inform about the actual diameter when ordering.

**TABLE 1**

Number of pumps	Number of kit no 2 - 3	Number of shaft seal kits	Number of Stuffing box + shaft sleeve	Number of rubber bush.	Number of kit no 9	Number of kit no. 4-5	Number of kit no. 7	Number of kit no. 1	Number of motor-bearings	Part no.	Stuffing box	Part no.
1	1	1	1	1	1	1	1	1	1	96433665	SNE	96029222
2	1	1	1	1	1	1	1	2	2	96433669	SNO	96029223
3	2	2	2	2	2	2	2	3	3	96433673	SNO	96029224
4	2	2	2	2	2	2	2	4	4	96433681	SNO	96029225
5	2	2	2	2	2	2	2	5	5	96433685	SNO	96029225
6	3	3	3	3	3	3	3	6	6	96433689	Sleeve with gasket + O-ring	96029599
7	3	3	3	3	3	3	3	7	7	96433693	Sleeve with gasket + O-ring	96029599
8	3	3	3	3	3	3	3	8	8	96029201		
9	3	3	3	3	3	3	3	9	9	96505023		
10	3	3	3	3	3	3	3	10	10	96421157		
										96029205		
										96029207		
										96029569		

## RECOMMENDED SPARE PARTS FOR 2 AND 5 YEARS' OPERATING TIME

← for 2 years operating → for 5 years operating →

NK Type	Motor size	4-poled motor [kW]	2-poled motor [kW]	Gasket kit EPDM No 2	Gasket kit FKM No 3	Shaft seal kit or stuffing box kit	Neck ring No 8	Neck ring No 8.1	Rubbers bushings for Standard coupling	Rubber bushings for Spacer coupling	Nut, key and thrower kit No 9	Impeller * GG 25 No 4	Impeller * Bronze No 5	Shaft AISI 420 No. 7	Bearing kit for bracket No 1	Motor bearing MMG model C DE	Motor bearing MMG model C ND
65 - 125	80	0.55 - 0.75	(-)	96432543	96432572	See table 1	96427836		96029498	96428978	96029520	96029361	96029398	96029461	96029238	96490842	96490842
	90S	1.1	(-)						96029499	96428978						1D6730	1D6730
	90L	1.5	(-)						96029500	96428978						96421472	96421472
	112M	(-)	4						96029501	96428979						96421473	96421473
	132S	(-)	5.5 - 7.5						96029501	96428979						1D6705	1D6705
	160M	(-)	11						96029498	96428978	96029520	96029362	96029399	96029461	96029238	96490842	96490842
65 - 160	80	0.75	(-)	96432544	96432573	See table 1	96427836		96029499	96428978	96029520	96029363	96029400	96029461	96029238	1D6730	1D6730
	90S	1.1	(-)						96029500	96428978						1D6732	1D6732
	90L	1.5	(-)						96029501	96428979						96421472	96421472
	112M	4	(-)						96029501	96428979						96421473	96421473
	132S	(-)	5.5 - 7.5						96029501	96428979						1D6705	1D6705
	160M	(-)	11.0 - 15.0						96029502	96428980	96029520	96029363	96029400	96029461	96029238	1D6703	1D6703
65 - 200	80	0.75	(-)	96432545	96432574	See table 1	96427836		96029503	96428981	96029520	96029363	96029400	96029461	96029238	1D6719	1D6719
	90L	1.5	(-)													1D6719	1D6719
	100L	2.2 - 3	(-)													1D6732	1D6732
	112M	4	(-)													96421472	96421472
	132S	(-)	7.5													96421473	96421473
	160M	(-)	11.0 - 15.0													1D6705	1D6705
180M	(-)	18.5													1D6705	1D6705	
200L	(-)	22													1D6703	1D6703	
		(-)	30												1D6719	1D6719	

\* The part number of the impeller is the impeller with max. diameter. Inform about the actual diameter when ordering.

TABLE 1

Shaft seal	Part no.	Stuffing box	Part no.
AQAV	96433665	SNE	96029222
AQOV	96433669	SNO	96029223
AQOE	96433673	SNF	96029224
DQOE	96433681	SFO	96029225
DOOV	96433685		
GOQE	96433689	Sleeve with gasket + O-ring	96029599
GQOV	96433693		
BAQE	96029701		
DAQF	96505023		
BQOE	96422157		
BQOV	96029205		
BAQV	96029207		
AQAE	96029569		

Number of pumps	Number of kit no 2 - 3	Number of shaft seal kits	Number of Stuffing box + shaft sleeve	Number of kit no 8-8.1	Number of rubber bush.	Number of kit no 9	Number of kit no. 4-5	Number of kit no. 7	Number of kit no. 1	Number of motor-bearings
1	1	1	1	1	1	1	1	1	1	1
2	1	1	1	1	1	1	1	1	2	2
3	2	2	2	2	2	2	2	2	3	3
4	2	2	2	2	2	2	2	2	4	4
5	2	2	2	2	2	2	2	2	5	5
6	3	3	3	3	3	3	3	3	6	6
7	3	3	3	3	3	3	3	3	7	7
8	3	3	3	3	3	3	3	3	8	8
9	3	3	3	3	3	3	3	3	9	9
10	3	3	3	3	3	3	3	3	10	10

**RECOMMENDED SPARE PARTS FOR 2 AND 5 YEARS' OPERATING TIME**

NK Type	Motor size	4-poled motor [kW]	2-poled motor [kW]	Gasket kit EPDM No.2	Gasket kit FKM No.3	Shaft seal kit or stuffing box kit	Neck ring		Rubber bushings for Standard coupling	Rubber bushings for Spacer coupling	Nut, key and thrower kit No.9	Impeller ★ CG 25 No.4	Impeller ★ Bronze No.5	Shaft AISI 420 No.7	Bearing kit for bracket No.1	Motor bearing MMG model C			
							No.8	No.8.1								DE	ND		
65 - 250	100L	2.2 - 3	(-)	96432548	96432577	See table 1	96427836	96427834	96029501	96428979	96029521	96029364	96029401	9602946	96029239	ID6732	ID6732		
	112M	4	(-)													96421472	96421472		
	132S	5.5	(-)														96421473	96421473	
	132M	7.5	(-)														ID6705	ID6705	
	160L	(-)	18.5													96029502	96428980	ID6703	ID6703
	180M	(-)	22													96029503	96428981	ID6719	ID6719
65 - 315	200L	(-)	30-37	96432550	96432579	See table 1	96427836	96427836	96029501	96428978	96029521	96029365	96029402	9602946	96029239	96421472	96421472		
	225M	(-)	45													96421473	96421473		
	132M	7.5	(-)														ID6705	ID6705	
	160L	15	(-)													96029502		ID6719	ID6719
65 - 315 ★★	200L	(-)	37	96432551	96432580	See table 2	96427836	96427836	96029503	96428981	96029522	96029366	96029403	96029463	96029240	ID6714	ID6714		
	225M	(-)	45													96029504	96428982	ID6724	ID6724
	250M	(-)	55													96029505	96428983	ID6946	ID6946
	280M	(-)	90																

for 2 years operating

for 5 years operating

★★ Oversize

★ The part number of the impeller is the impeller with max. diameter. Inform about the actual diameter when ordering.

TABLE 1 TABLE 2

Number of pumps	Number of kit no. 2 - 3	Number of shaft seal kits	Number of Stuffing box +shaft sleeve	Number of kit no. 8-8.1	Number of rubber bush.	Number of kit no. 9	Number of kit no. 4-5	Number of kit no. 7	Number of kit no. 1	Number of motor-bearings	TABLE 1		TABLE 2		
											Shaft seal	Part no.	Part no.	Part no.	
1	1	1	1	1	1	1	1	1	1	1	AQAV	96433666	96433667	SNE	96029226
2	1	1	1	1	1	1	1	2	2	2	AQQV	96433670	96433671	SNO	96029227
3	2	2	2	2	2	2	2	3	3	3	AQQE	96433674	96433675	SNF	96029228
4	2	2	2	2	2	2	2	4	4	4	DQQE	96433682	96433683	SKO	96029229
5	2	2	2	2	2	2	2	5	5	5	DQQV	96433690	96433687	Sleeve with gasket + O-ring	
6	3	3	3	3	3	3	3	6	6	6	GQQE	96498630	96433691		96029600
7	3	3	3	3	3	3	3	7	7	7	GQQV	96433694	96433695		96029601
8	3	3	3	3	3	3	3	8	8	8	BAQE	96029208	96029215		
9	3	3	3	3	3	3	3	9	9	9	DAQF	96503022	96504926		
10	3	3	3	3	3	3	3	10	10	10	BQQE	96422158	96422159		
											BAQV	96029212	96029219		
											BAQV	96029214	96029221		
											AQAE	96029570	96029571		

## RECOMMENDED SPARE PARTS FOR 2 AND 5 YEARS' OPERATING TIME

← for 2 years operating → for 5 years operating →

← for 2 years operating →

NK Type	Motor size	4-poled motor [kW]	2-poled motor [kW]	Gasket kit EPDM No 2	Gasket kit FKM No 3	Shaft seal kit or stuffing box kit	Neck ring No 8	Neck ring No 8.1	Rubber bushings for Standard coupling	Rubber bushings for Spacer coupling	Nut, key and thrower kit No 9	Impeller ★ CG 25 No 4	Impeller ★ Bronze No 5	Shaft AISI 420 No. 7	Bearing kit for bracket No 1	Motor bearing MMC model C DE	Motor bearing MMC model C ND
80 - 160	90S	1.1	(-)	96432544	96432573	See table 1	96427837		96029499	96428978	96029520	96029367	96029404	96029461	96029238	ID6730	ID6730
	90L	1.5	(-)						96029500							ID6732	ID6732
	100L	2.2 - 3	(-)						96029501	96428979						96421473	96421473
	132S	(-)	7.5													ID6705	ID6705
	160M	(-)	9.0 - 15													ID6703	ID6703
	160L	(-)	18.5						96029502	96428980						ID6719	ID6719
	180M	(-)	22						96029503	96428981						ID6732	ID6732
	200L	(-)	30						96029501	96428978	96029521	96029368	96029405	9602946	96029239	96421472	96421472
	112M	4	(-)	96432546	96432575	See table 2	96427837	96427837		96428979						96421473	96421473
	132S	5.5	(-)													ID6705	ID6705
132M	7.5	(-)													ID6703	ID6703	
160M	(-)	15													ID6719	ID6719	
160L	(-)	18.5							96029502	96428980					ID6732	ID6732	
180M	(-)	22						96029503	96428981						96421472	96421472	
200L	(-)	30-37							96428982						ID6724	ID6724	
225M	(-)	45		96432548	96432577	See table 2	96427837	96427837		96428979	96029521	96029369	96029406	96029239	ID6946	ID6946	
100L	3	(-)							96029501	96428978					ID6705	ID6705	
112M	4	(-)													ID6703	ID6703	
132S	5.5	(-)							96029502	96428980					ID6719	ID6719	
132M	7.5	(-)							96029503	96428981					ID6732	ID6732	
160M	(-)	18.5													96421472	96421472	
160L	(-)	18.5							96029504	96428982					96421473	96421473	
180M	(-)	22							96029505	96428983					ID6705	ID6705	
200L	(-)	30-37													ID6719	ID6719	
225M	(-)	45													ID6732	ID6732	
250M	(-)	55													ID6724	ID6724	
280S	(-)	75													ID6946	ID6946	

★ The part number of the impeller is the impeller with max. diameter. Inform about the actual diameter when ordering.

TABLE 1 TABLE 2

Number of pumps	Number of kit no 2 - 3	Number of shaft seal kits	Number of Stuffing box +shaft sleeve	Number of kit no 8-8.1	Number of rubber bush.	Number of kit no 9	Number of kit no. 4-5	Number of kit no. 7	Number of kit no. 1	Number of motor-bearings	TABLE 1		TABLE 2		
											Shaft seal	Part no.	Part no.	Part no.	
1	1	1	1	1	1	1	1	1	1	1	AOAV	96433665	96433666	96029222	96029230
2	1	1	1	1	1	1	1	1	2	2	AQOV	96433669	96433670	96029223	96029231
3	2	2	2	2	2	2	2	2	3	3	AQOE	96433673	96433674	96029224	96029232
4	2	2	2	2	2	2	2	2	4	4	DQOE	96433681	96433682	96029225	96029233
5	2	2	2	2	2	2	2	2	5	5	DQOV	96433685	96433690		
6	3	3	3	3	3	3	3	3	6	6	GOQE	96433689	96498630	Sleeve with gasket + O-ring	
7	3	3	3	3	3	3	3	3	7	7	GQOV	96433693	96433694	96029599	96029601
8	3	3	3	3	3	3	3	3	8	8	BAQE	96029201	96029208		
9	3	3	3	3	3	3	3	3	9	9	DAQF	96505023	96505022		
10	3	3	3	3	3	3	3	3	10	10	BQQE	96422157	96422158		
											BAQV	96029207	96029214		
											AOAE	96029569	96029570		

**RECOMMENDED SPARE PARTS FOR 2 AND 5 YEARS' OPERATING TIME**

NK Type	Motor size	4-poled motor [kW]	2-poled motor [kW]	Gasket kit EPDM No 2	Gasket kit FKM No 3	Shaft seal kit or stuffing box kit	Neck ring No 8	Neck ring No 8.1	Rubber bushings for Standard coupling	Rubber bushings for Spacer coupling	Nut, key and thrower kit No 9	Impeller * GG 25 No 4	Impeller * Bronze No 5	Shaft AISI 420 No.7	Bearing kit for bracket No 1	Motor bearing MMG model C DE	Motor bearing MMG model C ND
80 - 315	132S	5.5	(-)	96432550	96432579	See table 1	96427837	96427836	96029501	96428979	96029521	96029370	96029407	9602946	96029239	96421473	96421473
	132M	7.5	(-)													ID6705	ID6705
	160M	11	(-)						96029502							ID6703	ID6703
	180L	15	(-)						96029503	96428981	96029522		96029408	96029463	96029240	ID6714	ID6714
80 - 315 **	180M	18.5	(-)	96432551	96432580	See table 2	96427837	96427836	96029504	96428982	96029522					ID6724	ID6724
	225M	(-)	45						96029505	96428983						ID6946	ID6946
	250M	(-)	55													96421475	96421475
	280S	(-)	75													ID6705	ID6705
	280M	(-)	90													ID6703	ID6703
80 - 400 **	180L	22	(-)	96432553	96432582	See table 2	96427837	96427836	96029502	96428980	96029522					ID6703	ID6703
	200L	30	(-)						96029503	96428981						ID6719	ID6719
	225S	37	(-)						96029504	96428982						ID6714	ID6714

\*\* Oversize

\* The part number of the impeller is the impeller with max. diameter. Inform about the actual diameter when ordering.

Number of pumps	Number of kit no 2 - 3	Number of shaft seal kits	Number of Stuffing box +shaft sleeve	Number of kit no 8-8.1	Number of rubber bush.	Number of kit no 9	Number of kit no 4-5	Number of kit no. 7	Number of kit no. 1	Number of motor-bearings	TABLE 1		TABLE 2		
											Shaft seal	Part no.	Parting box	Part no.	
1	1	1	1	1	1	1	1	1	1	1	AQAV	96433666	96433667	96029226	96029230
2	1	1	1	1	1	1	1	1	1	2	AQOV	96433670	96433671	SNO	96029227
3	2	2	2	2	2	2	2	2	3	3	AQOE	96433674	96433675	SNF	96029228
4	2	2	2	2	2	2	2	2	4	4	DOQE	96433682	96433683	SKO	96029229
5	2	2	2	2	2	2	2	2	5	5	DQOV	96433690	96433687		96029233
6	3	3	3	3	3	3	3	3	6	6	GOQE	96498630	96433691	Sleeve with gasket + O-ring	
7	3	3	3	3	3	3	3	3	7	7	GOOV	96433694	96433695		96029600
8	3	3	3	3	3	3	3	3	8	8	BAQE	96029208	96029215		
9	3	3	3	3	3	3	3	3	9	9	DAQF	96505022	96504926		
10	3	3	3	3	3	3	3	3	10	10	BQOE	96422158	96422159		
											BQOV	96029212	96029219		
											BAOV	96029214	96029221		
											AQAE	96029570	96029571		

## RECOMMENDED SPARE PARTS FOR 2 AND 5 YEARS' OPERATING TIME

← for 2 years operating → for 5 years operating →

NK Type	Motor size	4-poled motor [kW]	2-poled motor [kW]	Gasket kit EPDM No 2	Gasket kit FKM No 3	Shaft seal kit or stuffing box kit	Neck ring No 8	Neck ring No 8.1	Rubber bushings for Standard coupling	Rubber bushings for Spacer coupling	Nut, key and thrower kit No 9	Impeller * GG 25 No 4	Impeller * Bronze No 5	Shaft AISI 420 No. 7	Bearing kit for bracket No 1	Motor bearing	Motor bearing
																MMG model C DE	MMG model C ND
100 - 200	100L	3	(-)	96432546	96432575	See table 1	96427839	96427838	96029501	96428978	96029521	96029372	96029409	9602946	96029239	ID6732	ID6732
	112M	4	(-)							96428979						96421472	96421472
	132S	5.5	(-)						96029502							ID6705	ID6705
	132M	7.5	(-)						96029503	96428981						ID6703	ID6703
	160M	11	(-)													ID6719	ID6719
	180M	(-)	22						96029504	96428982						ID6714	ID6714
	200L	(-)	30-37						96029505	96428983						ID6724	ID6724
	225M	(-)	45						96029501	96428979						ID6946	ID6946
	250M	(-)	55													96421473	96421473
	280S	(-)	75													ID6705	ID6705
100 - 250	132M	7.5	(-)	96432548	96432577	See table 1	96427839	96427838	96029502		96029521	96029373	96029410	9602946	96029239	ID6703	ID6703
	160M	11	(-)						96029503	96428980						ID6719	ID6719
	160L	15	(-)													ID6714	ID6714
	180M	18.5	(-)							96428981						ID6724	ID6724
	180L	22	(-)						96029504	96428982						ID6946	ID6946
	200L	(-)	37														
	225M	(-)	45														
	250M	(-)	55														
	280S	(-)	75														
	280M	(-)	90						96029505	96428983							

\* The part number of the impeller is the impeller with max. diameter. Inform about the actual diameter when ordering.

TABLE 1

Number of pumps	Number of kit no 2 - 3	Number of shaft seal kits	Number of stuffing box + shaft sleeve	Number of kit no 8-8.1	Number of rubber bush.	Number of kit no 9	Number of kit no. 4-5	Number of kit no. 7	Number of kit no. 1	Number of motor-bearings	Part no.	Stuffing box	Part no.
1	1	1	1	1	1	1	1	1	1	1	96433666	SNE	96029226
2	1	1	1	1	1	1	1	1	2	2	96433670	SNO	96029227
3	2	2	2	2	2	2	2	2	3	3	96433674	SNF	96029228
4	2	2	2	2	2	2	2	2	4	4	96433682	SKO	96029229
5	2	2	2	2	2	2	2	2	5	5	96433690		
6	3	3	3	3	3	3	3	3	6	6		Sleeve with gasket + O-ring	96029600
7	3	3	3	3	3	3	3	3	7	7	96433694		
8	3	3	3	3	3	3	3	3	8	8	96029208		
9	3	3	3	3	3	3	3	3	9	9	96505022		
10	3	3	3	3	3	3	3	3	10	10	96422158		
											96029214		
											96029570		

**RECOMMENDED SPARE PARTS FOR 2 AND 5 YEARS' OPERATING TIME**



NK Type	Motor size	4-poled motor [kW]	2-poled motor [kW]	Gasket kit EPDM No 2	Gasket kit FKM No 3	Shaft seal kit or stuffing box kit	Neck ring No 8	Neck ring No 8.1	Rubber bushings for Standard coupling	Rubber bushings for Spacer coupling	Nut, key and thrower kit No 9	Impeller ★ GG 25 No 4	Impeller ★ Bronze No 5	Shaft AISI 420 No. 7	Bearing kit for bracket No. 1	Motor bearing MMG model C DE	Motor bearing MMG model C ND
100 - 315	132M	7.5	(-)	96432550	96432579	See table 1	96427840	96427840	96029501	96428979	96029521	96029374	96029411	96029446	96029239	96421473	96421473
	160M	11	(-)						96029501						96029239	ID6705	ID6705
	160L	15	(-)						96029502	96428980						ID6703	ID6703
	180M	18.5	(-)						96029502							ID6724	ID6724
	180L	22	(-)						96029503							ID6946	ID6946
100 - 315 ★★	250M	(-)	55	96432551	96432580	See table 2	96427840	96427840	96029504	96428982	96029522	96029375	96029412	96029463	96029240	96421475	96421474
	280S	(-)	75						96029505	96428983							
	280M	(-)	90														
	315S	(-)	110														
	315M	(-)	132														
100 - 400	160L	15	(-)	96432554	96432583	See table 2	96427840	96427839	96029506	96428984	96029522	96029676	96029513	96029463	96029240	ID6705	ID6705
	180M	18.5	(-)						96029502	96428980						ID6703	ID6703
	180L	22	(-)						96029503	96428981						ID6719	ID6719
	200L	30	(-)						96029503	96428981						ID6714	ID6714
	225S	37	(-)						96029504	96428982						ID6724	ID6724
250M	45	(-)							96029505	96428983						ID6946	ID6946
	55	(-)							96029506	96428984						ID6946	ID6946

★★ Oversize

★ The part number of the impeller is the impeller with max. diameter. Inform about the actual diameter when ordering.

TABLE 1

TABLE 2

Number of pumps	Number of kit no 2 - 3	Number of shaft seal kits	Number of Stuffing box +shaft sleeve	Number of kit no 8-8.1	Number of rubber bush.	Number of kit no 9	Number of kit no 4-5	Number of kit no. 7	Number of kit no. 1	Number of motor-bearings	TABLE 1		TABLE 2			
											Shaft seal	Part no.	Part no.	Part no.		
1	1	1	1	1	1	1	1	1	1	1	AQAV	96433666	96433667	SNE	96029226	96029230
2	1	1	1	1	1	1	1	2	2	2	AQOV	96433670	96433671	SNO	96029227	96029231
3	2	2	2	2	2	2	2	3	3	3	AQOE	96433674	96433675	SNF	96029228	96029232
4	2	2	2	2	2	2	2	4	4	4	DQOE	96433682	96433683	SIO	96029229	96029233
5	2	2	2	2	2	2	2	5	5	5	DQOV	96433690	96433687			
6	3	3	3	3	3	3	3	6	6	6	CQOE	96498630	96433691	Sleeve with gasket + O-ring	96029215	96029601
7	3	3	3	3	3	3	3	7	7	7	CQOV	96433694	96433695			
8	3	3	3	3	3	3	3	8	8	8	BAQE	96029208	96029215			
9	3	3	3	3	3	3	3	9	9	9	DAQF	96505022	96504926			
10	3	3	3	3	3	3	3	10	10	10	BOQE	96422158	96422159			
											BQOV	96029212	96029219			
											BAQV	96029214	96029221			
											AQAE	96029570	96029571			

## RECOMMENDED SPARE PARTS FOR 2 AND 5 YEARS' OPERATING TIME

for 5 years operating

for 2 years operating

NK Type	Motor size	4-poled motor [kW]	2-poled motor [kW]	Gasket kit EPDM No 2	Gasket kit FKM No 3	Shaft seal kit or stuffing box kit	Neck ring No 8	Neck ring No 8.1	Rubber bushings for Standard coupling	Rubber bushings for Spacer coupling	Nut, key and thrower kit No 9	Impeller * GG 25 No 4	Impeller * Bronze No 5	Shaft AISI 420 No. 7	Bearing kit for bracket No 1	Motor bearing MMG model C DE	Motor bearing MMG model C ND
125 - 250	132S	5.5	(-)	96432548	96432577	See table 1	96427840	96427838	96029501	96428979	96029521	96029377	96029414	96029462	96029239	96421473	96421473
	132M	7.5	(-)						96029502							ID6705	ID6705
	160M	11	(-)						96029503	96428981	96029522	96029378	96029415	96029463	96029240	ID6703	ID6703
	160L	15	(-)						96029504	96428982						ID6719	ID6719
	180M	18.5	(-)						96029505	96428983						ID6714	ID6714
125 - 250 **	200L	(-)	37	96432549	96432578	See table 1	96427840	96427838								ID6724	ID6724
	225M	(-)	45													ID6946	ID6946
	250M	(-)	55													96421475	96421474
	280S	(-)	75													ID6705	ID6705
	280M	(-)	90			See table 2										ID6703	ID6703
125 - 315	315S	(-)	110				96427840	96427840	96029501	96428979	96029522	96029379	96029416	96029463	96029240	ID6719	ID6719
	315M	(-)	132	96432551	96432580	See table 2			96029502	96428981						ID6705	ID6705
	160L	15	(-)						96029503	96428982						ID6703	ID6703
	180M	18.5	(-)							96428983						ID6719	ID6719
	180L	22	(-)													ID6714	ID6714
125 - 400	200L	30	(-)	96432554	96432583	See table 2	96427840	96427839	96029502	96428980	96029522	96029380	96029417	96029463	96029240	ID6724	ID6724
	160L	15	(-)						96029503	96428981						ID6946	ID6946
	180M	18.5	(-)							96428982							
	200L	30	(-)														
	225S	37	(-)						96029504	96428982							
250M	45	(-)							96029505	96428983							
	55	(-)							96029506	96428984							

\*\* Oversize

\* The part number of the impeller is the impeller with max. diameter. Inform about the actual diameter when ordering.

TABLE 1 TABLE 2

Number of pumps	Number of kit no. 2 - 3	Number of shaft seal kits	Number of stuffing box + shaft sleeve	Number of kit no. 8-8.1	Number of rubber bush.	Number of kit no. 9	Number of kit no. 4-5	Number of kit no. 7	Number of kit no. 1	Number of motor-bearings	TABLE 1		TABLE 2		
											Shaft seal	Part no.	Part no.	Part no.	
1	1	1	1	1	1	1	1	1	1	1	AQAV	96433666	96433667	96029226	96029230
2	1	1	1	1	1	1	1	1	2	2	AQOV	96433670	96433671	96029227	96029231
3	2	2	2	2	2	2	2	3	3	3	AQOE	96433674	96433675	96029228	96029232
4	2	2	2	2	2	2	2	4	4	4	DOOE	96433682	96433683	96029229	96029233
5	2	2	2	2	2	2	2	5	5	5	DQOV	96433690	96433687		
6	3	3	3	3	3	3	3	6	6	6	QOOE	96498630	96433691	Sleeve with gasket + O-ring	
7	3	3	3	3	3	3	3	7	7	7	GQOV	96433694	96433695	96029600	96029601
8	3	3	3	3	3	3	3	8	8	8	BAQE	96029208	96029215		
9	3	3	3	3	3	3	3	9	9	9	DAQF	96505022	96504926		
10	3	3	3	3	3	3	3	10	10	10	BQOE	96422158	96422159		
											BQOV	96029212	96029219		
											BAOV	96029214	96029221		
											AQAE	96029570	96029571		

**RECOMMENDED SPARE PARTS FOR 2 AND 5 YEARS' OPERATING TIME**

← for 2 years operating → for 5 years operating →

← for 2 years operating →

NK Type	Motor size	4-poled motor [kW]	2-poled motor [kW]	Gasket kit EPDM No 2	Gasket kit FKM No 3	Shaft seal kit or stuffing box kit	Neck ring No 8	Neck ring No 8.1	Rubber bushings for Standard coupling	Rubber bushings for Spacer coupling	Nut, key and thrower kit No 9	Impeller * GG 25 No 4	Impeller * Bronze No 5	Shaft AISI 420 No. 7	Bearing kit for bracket No 1	Motor bearing MMG model C DE	Motor bearing MMG model C ND
150 - 315	160M	11	(-)	96432551	96432580	See table 1	96427842	96427840	96029501	96428979	96029522	96029381	96029418	96029463	96029240	ID6705	ID6705
	160L	15	(-)						96029502	96428980						ID6703	ID6703
	180M	18.5	(-)						96029503	96428981						ID6719	ID6719
	180L	22	(-)						96029504	96428982						ID6714	ID6714
	200L	30	(-)						96029505	96428983						ID6946	ID6946
	225S	37	(-)													96421475	96421475
	225M	45	(-)														
	280M	(-)	90														
	315S	(-)	110														
	315M	(-)	132														
150 - 315 **	315LK	(-)	160	96432552	96432581	See table 2	96427842	96427840	96029506	96428984	96029522	96029381	96029418	96029465	96029241	96421475	96421474
	355L	(-)	200						96029507	96428985							
	355S	(-)	250						96029507	96428985							
	355M	(-)	315						96029509	96428986							
150 - 320	200L	30	(-)	96432551	96432580	See table 1	96427842	96427840	96029503	96428980	96029522	96436894	96436892	96029463	96029240	ID6703	ID6703
	225S	37	(-)						96029504	96428981						ID6719	ID6719
	225M	45	(-)						96029504	96428982						ID6714	ID6714
	250M	55	(-)						96029505	96428983						ID6724	ID6724
	280S	75	(-)	96432554	96432583	See table 1	96427843	96427841	96029503	96428980	96029522	96029382	96029419	96029463	96029240	ID6703	ID6703
150 - 400	200L	30	(-)						96029504	96428982						ID6719	ID6719
	225S	37	(-)						96029504	96428982						ID6714	ID6714
	225M	45	(-)						96029505	96428983						ID6724	ID6724
	250M	55	(-)						96029505	96428983						ID6703	ID6703
	280S	75	(-)						96029506	96428984						ID6714	ID6714
150 - 400	280M	90	(-)						96029507	96428985						ID6946	ID6946
	315S	110	(-)													96421475	96421474

\*\* Oversize

\* The part number of the impeller is the impeller with max. diameter. Inform about the actual diameter when ordering.

TABLE 1

TABLE 2

Number of pumps	Number of kit no 2 - 3	Number of shaft seal kits	Number of Stuffing box + shaft sleeve	Number of kit no 8-8.1	Number of rubber bush.	Number of kit no 9	Number of kit no 4-5	Number of kit no. 7	Number of kit no. 1	Number of motor-bearings	TABLE 1		TABLE 2		
											Shaft seal	Part no.	Stuffing box	Part no.	
1	1	1	1	1	1	1	1	1	1	1	AQAV	96433667	96433668	96029230	96029234
2	1	1	1	1	1	1	1	1	2	2	AOQV	96433671	96433672	96029231	96029235
3	2	2	2	2	2	2	2	2	3	3	AQOE	96433675	96433676	96029232	96029236
4	2	2	2	2	2	2	2	2	4	4	DQOE	96433683	96433684	96029233	96029237
5	2	2	2	2	2	2	2	2	5	5	DQOV	96433687	96433688		
6	3	3	3	3	3	3	3	3	6	6	CQOE	96433691	96433692	Sleeve with gasket + O-ring	96029601
7	3	3	3	3	3	3	3	3	7	7	GOQV	96433695	96433696		
8	3	3	3	3	3	3	3	3	8	8	BAQE	96029215	96029250		
9	3	3	3	3	3	3	3	3	9	9	DAQF	96504926	96504927		
10	3	3	3	3	3	3	3	3	10	10	BQOE	96422159	96422160		
											BQOV	96029219	96029258		
											BAQV	96029221	96029562		
											AQAE	96029571	96029572		

## RECOMMENDED SPARE PARTS FOR 2 AND 5 YEARS' OPERATING TIME

← for 2 years operating → for 5 years operating →

NK Type	Motor size	4-poled motor [kW]	2-poled motor [kW]	Gasket kit EPDM No 2	Gasket kit FKM No 3	Shaft seal kit or stuffing box kit	Neck ring No 8	Neck ring No 8.1	Rubber bushings for Standard coupling	Rubber bushings for Spacer coupling	Nut, key and thrower kit No 9	Impeller * GG 25 No 4	Impeller * Bronze No 5	Shaft AISI 420 No. 7	Bearing kit for bracket No 1	Motor bearing MMGC model C DE	Motor bearing MMGC model C ND
200 - 400 **	225M	45	(-)	96432555	96432584	See table 1	96427844	96427844	96029504	96428982	96029523	96029383	96029420	96029464	96029241	ID6714	ID6714
	250M	55	(-)						96029505	96428983						ID6724	ID6724
	280S	75	(-)						96029506	96428984						ID6946	ID6946
	280M	90	(-)														
	315S	110	(-)						96029507	96428985						96421476	96421476
200 - 500 **	315M	132	(-)														
	315LK	160	(-)						96029505	96428983	96029523	96029384	96029421	96029465	96029241	ID6724	ID6724
	315L	200	(-)				96427845	96427845	96029506	96428984						ID6946	ID6946
	355S	250	(-)						96029507	96428985						96421476	96421476
									96029591	96428986						96421477	96421477

\*\* Oversize  
\* The part number of the impeller is the impeller with max. diameter. Inform about the actual diameter when ordering.

TABLE 1

Shaft seal	Part no.	Stuffing box	Part no.
AOAV	96433668	SNE	96029234
AOQV	96433672	SNO	96029235
AOQE	96433676	SNF	96029236
DOQE	96433684	SKO	96029237
DOQV	96433688		
GOQE	96433692	Sleeve with gasket + O-ring	96029602
BAQE	96029550		
DAQF	96504927		
BOQE	96422160		
BQOV	96029558		
BAQV	96029562		
AOAE	96029572		

Number of pumps	Number of kit no 2 - 3	Number of shaft seal kits	Number of Stuffing box + shaft sleeve	Number of kit no 8-8.1	Number of rubber bush.	Number of kit no 9	Number of kit no. 4-5	Number of kit no. 7	Number of kit no. 1	Number of motor-bearings
1	1	1	1	1	1	1	1	1	1	1
2	1	1	1	1	1	1	1	1	2	2
3	2	2	2	2	2	2	2	2	3	3
4	2	2	2	2	2	2	2	2	4	4
5	2	2	2	2	2	2	2	2	5	5
6	3	3	3	3	3	3	3	3	6	6
7	3	3	3	3	3	3	3	3	7	7
8	3	3	3	3	3	3	3	3	8	8
9	3	3	3	3	3	3	3	3	9	9
10	3	3	3	3	3	3	3	3	10	10

**RECOMMENDED SPARE PARTS FOR 2 AND 5 YEARS' OPERATING TIME**

NK Type	Motor size	4-poled motor [kW]	2-poled motor [kW]	Gasket kit EPDM No 2	Gasket kit FKM No 3	Shaft seal kit or stuffing box kit	Neck ring No 8	Neck ring No 8.1	Rubber bushings for Standard coupling	Rubber bushings for Spacer coupling	Nut, key and thrower kit No 9	Impeller ★ GG 25 No 4	Impeller ★ Bronze No 5	Shaft AISI 420 No. 7	Bearing kit for bracket No 1	Motor bearing MMG model C DE	Motor bearing MMG model C ND
250 - 310 ★★	200l	30	(-)	96432556	96432585	See table 1	96432595	96432594	96029503 96029504	96428981 96428982	96029522	96432854 96432855	96029463	96029240	ID6719 ID6714	ID6719 ID6714	
	225s	37	(-)														
	225m	45	(-)														
	250M	55	(-)													ID6724 ID6946	ID6724 ID6946
250 - 330 ★★	280S	75	(-)	96432557	96432586	See table 2	96427844	96427844	96029505 96029506	96428983 96428984	96029523	96432856 96432857	96029464	96029241	ID6724 ID6946	ID6724 ID6946	
	250M	55	(-)														
	280M	90	(-)														
	315S	110	(-)												96421476	96421476	96421476
250 - 400 ★★	250M	55	(-)	96432558	96432587	See table 2	96427846	96427846	96029505 96029506	96428983 96428984	96029523	96029385 96029422	96029465	96029241	ID6724 ID6946	ID6724 ID6946	
	280S	75	(-)														
	280M	90	(-)														
	315S	110	(-)												96421476	96421476	96421476
250 - 500 ★★	315M	132	(-)														
	315Lk	160	(-)														
	315L	200	(-)	96432559	96432588	See table 2	96427845	96427845	96029506 96029507	96428984 96428985	96029523	96029386 96029423	96029465	96029241	ID6946 96421476	ID6946 96421476	
	355S	250	(-)														
355M	315	(-)						96029592	96428987					96421477	96421477	96421477	

for 5 years operating

for 2 years operating

★★ Oversize  
★ The part number of the impeller is the impeller with max. diameter. Inform about the actual diameter when ordering.

Number of pumps	Number of kit no 2 - 3	Number of shaft seal kits	Number of Stuffing box +shaft sleeve	Number of kit no 8-8.1	Number of rubber bush.	Number of kit no 9	Number of kit no. 4-5	Number of kit no. 7	Number of kit no. 1	Number of motor-bearings	TABLE 1		TABLE 2			
											Part no.	Part no.	Part no.	Part no.		
1	1	1	1	1	1	1	1	1	1	1	AQAV	96433667	96433668	SNE	96029230	96029234
2	1	1	1	1	1	1	1	1	2	2	AQQV	96433671	96433672	SNO	96029231	96029235
3	2	2	2	2	2	2	2	3	3	3	AQQE	96433675	96433676	SNF	96029232	96029236
4	2	2	2	2	2	2	2	4	4	4	DQOE	96433683	96433684	SKO	96029233	96029237
5	2	2	2	2	2	2	2	5	5	5	DQQV	96433687	96433688			
6	3	3	3	3	3	3	3	6	6	6	GOQE	96433691	96433692	Sleeve with gasket + O-ring	96029601	96029602
7	3	3	3	3	3	3	3	7	7	7	GQQV	96433695	96433696			
8	3	3	3	3	3	3	3	8	8	8	BAQE	96029215	96029550			
9	3	3	3	3	3	3	3	9	9	9	DAQF	96504926	96504927			
10	3	3	3	3	3	3	3	10	10	10	BQQV	96421159	96422160			
											BQQV	96029219	96029558			
											BAQV	96029221	96029562			
											AQAE	96029571	96029572			

## RECOMMENDED SPARE PARTS FOR 2 AND 5 YEARS' OPERATING TIME



NK Type	Motor size	4-poled motor [kW]	2-poled motor [kW]	Gasket kit EPDM No 2	Gasket kit FKM No 3	Shaft seal kit or stuffing box kit	Neck ring No 8	Neck ring No 8.1	Rubber bushings for Standard coupling	Rubber bushings for Spacer coupling	Nuts, key and thrower kit No 9	Impeller * GG 25 No 4	Impeller * Bronze No 5	Shaft AISI 420 No. 7	Bearing kit for bracket No 1	Motor bearing	Motor bearing
																MMG model C DE	MMG model C ND
300 -360	225M	45	(-)	96432560	96432589	See table 1	96427846	96427847	96029504	96428982	96029523	96029579	96029581	96029465	96029241	ID6714	ID6714
	250M	55	(-)						96029505	96428983						ID6724	ID6724
	280S	75	(-)						96029506	96428984						ID6946	ID6946
	280M	90	(-)														

\* The part number of the impeller is the impeller with max. diameter. Inform about the actual diameter when ordering.

TABLE 1

Shaft seal	Part no.	Stuffing box	Part no.
AOAV	96433668	SNE	96029234
AOQV	96433672	SNO	96029235
AOQE	96433676	SNF	96029236
DOQE	96433684	SKO	96029237
DOQV	96433688	Sleeve with gasket + O-ring	96029602
GOQE	96433692		
GOQV	96433696		
BAQE	96029550		
DAQF	96504927		
BOQE	96422160		
BOQV	96029558		
BAQV	96029562		
AOQE	96029572		

Number of pumps	Number of kit no 2 - 3	Number of shaft seal kits	Number of Stuffing box + shaft sleeve	Number of kit no 8-8.1	Number of rubber bush.	Number of kit no 9	Number of kit no. 4-5	Number of kit no. 7	Number of kit no. 1	Number of motor-bearings
1	1	1	1	1	1	1	1	1	1	1
2	1	1	1	1	1	1	1	1	2	2
3	2	2	2	2	2	2	2	2	3	3
4	2	2	2	2	2	2	2	2	4	4
5	2	2	2	2	2	2	2	2	5	5
6	3	3	3	3	3	3	3	3	6	6
7	3	3	3	3	3	3	3	3	7	7
8	3	3	3	3	3	3	3	3	8	8
9	3	3	3	3	3	3	3	3	9	9
10	3	3	3	3	3	3	3	3	10	10

# NM 50, 65, 80, 100

## RECOMMENDED SPARE PARTS FOR 2 AND 5 YEARS' OPERATING TIME

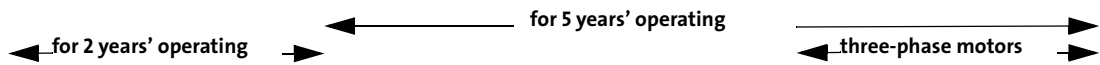

Type	Shaft seal BUBE	Shaft seal AUUE	Service kit BUBE and shaft	Service kit AUUE and shaft	Impeller	ND-Motor bearing	DE-Motor bearing
NM 50-32-125/142	485351	485113	485352	485125	485250	96490769	96490842
NM 50-32-160/150	485351	485113	485352	485125	485252	96490769	96490842
NM 50-32-160/165	485351	485113	485352	485125	485251	96490769	96490842
NM 50-32-200/191	485351	485113	485352	485125	485262	96490769	96490842
NM 50-32-200/205	485351	485113	485352	485125	485258	96490769	96490842
NM 65-50-125/128	485351	485113	485352	485125	485007	96490769	96490842
NM 65-50-160/154	485351	485113	485352	485125	485244	96490769	96490842
NM 65-50-160/165	485351	485113	485352	485125	485243	96490769	96490842
NM 65-40-200/198	485351	485113	485352	485125	485246	96490769	96490842
NM 65-40-200/210	485351	485113	485352	485125	485245	96490844	96490848
NM 80-65-125/133	485351	485113	485352	485125	485005	96490769	96490842
NM 80-65-160/154	485351	485113	485352	485125	475014	96490769	96490842
NM 80-65-160/168	485351	485113	485352	485125	475013	96490844	96490848
NM 80-50-200/187	485351	485113	485352	485125	485058	96490844	96490848
NM 80-50-200/202	485351	485113	485352	485125	485016	96490844	96457053
NM 100-80-125/136	485351	485113	485352	485125	475004	96490769	96490842
NM 100-80-125/140	485351	485113	485352	485125	475001	96490844	96490848
NM 100-80-160/162	485351	485113	485352	485125	485060	96490844	96490848
NM 100-80-160/168	485351	485113	485352	485125	485015	96490844	96457053
NM 100-65-200/187	485278	485114	485279	485122	485057	96490844	96457053
NM 100-65-200/200	485278	485114	485279	485122	485056	96490844	96457053
NM 100-65-200/210	485278	485114	485279	485122	485019	96457052	96457053

Number of pumps	Number of shaft seals	Number of service kits	Number of impellers	Lower ball bearings	Upper ball bearings
1	1	1	1	1	1
2	1	1	1	2	2
3	2	2	2	3	3
4	2	2	2	4	4
5	2	2	2	5	5
6	3	3	3	6	6
7	3	3	3	7	7
8	3	3	3	8	8
9	3	3	3	9	9
10	3	3	3	10	10

Example: Spare parts for 4 units NM 50-32-125/142 with BUBE shaft seal.

2 years of operating:

2 off shaft seal kits: 485351

5 years of operating:

2 off service kits: 485352

4 off ND motor bearings: 96490769

4 off DE motor bearings: 96490842

# NP 50, 65, 80, 100

## RECOMMENDED SPARE PARTS FOR 2 AND 5 YEARS' OPERATING TIME

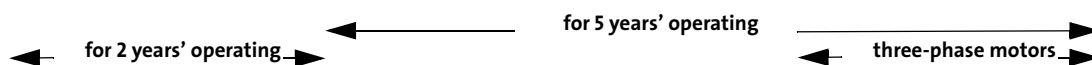

Type	Shaft seal BUBE BBUE	Shaft seal AUUE BUUE	Service kit BUBE and shaft	Service kit AUUE and shaft	Impeller	ND-Motor bearing	DE-Motor bearing
NP 50-32-125/132	485351	485113	485352	485125	485254	96490769	96490842
NP 50-32-125/142	485351	485113	485352	485125	485250	96490844	96490848
NP 50-32-160/152	485351	485113	485352	485125	485253	96490844	96490848
NP 50-32-160/165	485351	485113	485352	485125	485251	96490844	96457053
NP 50-32-200/185	485351	485113	485352	485125	485257	96457052	96457053
NP 50-32-200/205	485278	485114	485279	485122	485255	96457053	96457054
NP 65-50-125/104	485351	485113	485352	485125	485069	96490844	96490848
NP 65-50-125/117	485351	485113	485352	485125	485068	96490844	96490848
NP 65-50-125/128	485351	485113	485352	485125	485007	96490844	96457053
NP 65-50-160/154	485351	485113	485352	485125	485244	96457052	96457053
NP 65-50-160/165	485278	485114	485279	485122	485247	96457053	96457054
NP 65-40-200/188	485278	485114	485279	485122	485242	96457053	96457054
NP 65-40-200/210	485278	485114	485279	485122	485241	96457053	96457054
NP 80-65-125/124	485351	485113	485352	485125	485066	96490844	96457053
NP 80-65-125/133	485351	485113	485352	485125	485005	96457052	96457053
NP 80-65-160/146	485278	485114	485279	485122	475012	96457053	96457054
NP 80-65-160/161	485278	485114	485279	485122	475015	96457053	96457054
NP 80-50-200/180	485278	485114	485279	485122	485062	00ID3139	00ID3215
NP 80-50-200/202	485278	485114	485279	485122	485011	00ID6706	00ID6707
NP 100-80-125/121	485351	485113	485352	485125	475003	96457052	96457053
NP 100-80-125/130	485278	485114	485279	485122	485064	96457053	96457054
NP 100-80-125/137	485278	485114	485279	485122	485010	96457053	96457054
NP 100-80-160/152	485278	485114	485279	485122	485067	00ID3139	00ID3215
NP 100-80-160/168	485278	485114	485279	485122	485012	00ID6706	00ID6707
NP 100-65-200/183	485353	485448	485354	485449	485055	00ID6706	00ID6707
NP 100-65-200/191	485353	485448	485354	485449	485032	00ID6709	00ID6712
NP 100-65-200/210	485353	485448	485354	485449	485017	00ID6711	00ID6710

Number of pumps	Number of shaft seals	Number of service kits	Number of impellers	Lower ball bearings	Upper ball bearings
1	1	1	1	1	1
2	1	1	1	2	2
3	2	2	2	3	3
4	2	2	2	4	4
5	2	2	2	5	5
6	3	3	3	6	6
7	3	3	3	7	7
8	3	3	3	8	8
9	3	3	3	9	9
10	3	3	3	10	10

**Example: Spare parts for 4 units NP 50-32-125/132 with BUBE shaft seal.**

2 years of operating:

2 off shaft seal kits: 485351

5 years of operating:

2 off service kits: 485352

2 off impellers: 485254

4 off ND motor bearings: 96490769

4 off DE motor bearings: 96490842

## RECOMMENDED SPARE PARTS FOR 2 TO 5 YEARS' OPERATING TIME

Type	Wear parts kit	
	Standard	N- execution
SP 17 1-5 (N) (R)	96421723	96421723
SP 17 6-16 (N) (R)	96421724	96421724
SP 17 17-26 (N) (R)	96421725	96421725
SP 17 27-40 (N) (R)	96440238	96440238
SP 30 1-5 (N) (R)	96421732	96421732
SP 30 6-16 (N) (R)	96421733	96421733
SP 30 17-27 (N) (R)	96421734	96421734
SP 30 28-35 (N) (R)	96440246	96440246
SP 46 2-6 (N) (R)	96440248	96440248
SP 46 7-10 (N) (R)	96440250	96440250
SP 46 11-16 (N) (R)	96440252	96440252
SP 46 17-24 (N) (R)	96440254	96440254
SP 60 2-6 (N) (R)	96440369	96440369
SP 60 7-10 (N) (R)	96440371	96440371
SP 60 11-16 (N) (R)	96440373	96440373
SP 60 17-22 (N) (R)	96440375	96440375
SP 77 1-8 (N)	96440256	96440256
SP 77 9-14 (N)	96440258	96440258
SP 77 15-20 (N)	96440260	96440260
SP 95 1-8 (N)	96440715	96440715
SP 95 9-14 (N)	96440716	96440716
SP 95 15-20 (N)	96440717	96440717
SP 125 1-4 (N) (R)	96440262	96440262
SP 125 5-6 (N) (R)	96440264	96440264
SP 125 7-10 (N) (R)	96440266	96440266
SP 160 1-5 (N)	205117	205117
SP 160 6-9 (N)	205118	205118
SP 215 1-2 (N)	185033	185033
SP 215 3-4 (N)	185034	185034
SP 215 5-7 (N)	185035	185035
SP 215 8-10 (N)	185036	185036

## CABLE TERMINATION KIT (SHRINK FLEX)

Kit no.	116251	116252	116255	116253	116254	116257	116258	116256
Cable type	Flat Cable			3 Single leads		4 Single leads		Single lead
mm <sup>2</sup>	1.5-6	6-16	16-25	1.5-6	10-25	1.5-4	6-16	35-120

Number of pumps	Number of Wear parts kit	Motor complete	Motor Cable	Cable termination kit
1-2	1	1	1	1
3-5	2	1	1	1
6-10	3	1	1	1
11-20	4	2	2	2

**Example: Spare parts for 4 units SP 46-10 standard version:**  
 2 off wear parts kit: 155120  
 1 Motor complete (find part number in data book)  
 1 Motor cable (find part number in data book)  
 1 Cable termination kit (find part number in Table 1)

## RECOMMENDED SPARE PARTS FOR 2 TO 5 YEARS' OPERATING TIME

**Pomona 07** With bearing housing and free shaft end.

2 years	5 years	Part number	Description	Pos.
Numbers				
1	2	S6563226	Impeller	2
–	1	S6563200	Motor stool	3
1	2	S6563439	Wear plate	4
–	1	S6563323	Pump shaft	20
–	1	S5503282	Ball bearing	25
–	1	S6503312	Ball bearing	26
1	2	S6508764	Impeller nut	43
1	2	S6510629	Pressure ring	53
1	2	S6511650	Shaft key	67
1	2	S6511846	Pin	69
1	2	S7522031	Gasket for pump housing	82
1	2	S6509043	Spacer	88
1	2	S6524751	Gasket for wear plate	91
1	2	S6524425	Shaft seal	90

**Pomona 23 (R)**

With free shaft end.

With three-phase motor on frame.

With gasolin motor.

2 years	5 years	Part number	Part number	Part number	Description	Pos.
Numbers						
1	2	S6564419	S6563790	S6563790	Impeller	2
–	1	S6563943	S6563943	S6564060	Motor stool	3
1	2	S6563960	S6563960	S6563960	Wear plate	4
–	1	S6564427			Pump shaft	20
–	1	S7503070			Ball bearing	25
–	1	S6503665			Ball bearing	26
1	2	S6508780	S6553441	S6553450	Impeller nut	43
1	2	S6564400	S6521256	S6521256	Pressure ring	53
1	2	S6510912			Shaft key	67
1	2	S5511773	S5511773	S5511773	Pin	69
–	1	S6520861	S6520861	S6520861	Seal ring	79
1	2	S6522090	S6522090	S6522090	Gasket for pump housing	82
1	2	S6524396	S6524396	S6524396	Spacer	88
1	2	S6553425	S6553425	S6553425	Gasket for wear plate	91
1	2	S6524395	S6524395	S6524395	Shaft seal	90

**Pomona 32 (R)**

With free shaft end.

With three-phase motor.

2 years	5 years	Part number	Part number	Description	Pos.
Numbers					
1	2	S6565440	S6565440	Impeller	2
1	2	S6565423	S6565423	Wear plate	4
–	1	S6565751		Pump shaft	20
–	1	S8503118		Ball bearing	25
–	1	S6503681		Ball bearing	26
1	2	S6554022	S6554022	Impeller nut	43
1	2	S6521213	S6521213	Pressure ring	53
1	2	S3511137	S3511137	Shaft key	67
1	2	S5511773	S5511773	Pin	69
–	1	S6520772	S6520772	Seal ring	79
1	2	S6522694	S6522694	Gasket for pump housing	82
1	2	S6524397	S6524397	Spacer	88
1	2	S6553980	S6553980	Gasket for wear plate	91
1	2	S6524417	S6524417	Shaft seal	90

**RECOMMENDED SPARE PARTS FOR 2 TO 5 YEARS' OPERATING TIME**

Pomona 42 (R)

With bearing housing and free shaft end.

2 years Numbers	5 years Numbers	Part number	Description	Pos.
1	2	S6563013	Impeller	2
1	2	S6563005	Wear plate	4
–	1	S6563072	Pump shaft	20
–	1	S6503118	Ball bearing	25
–	1	S6503681	Ball bearing	26
1	2	S6554022	Impeller nut	43
1	2	S6521213	Pressure ring	53
1	2	S6511242	Shaft key	67
1	2	S5511773	Pin	69
–	1	S6520772	Seal ring	79
–	2	S6522708	Gasket for pump housing	82
1	2	S6524397	Spacer	88
1	2	S6553166	Gasket for wear plate	91
1	2	S6524417	Shaft seal	90

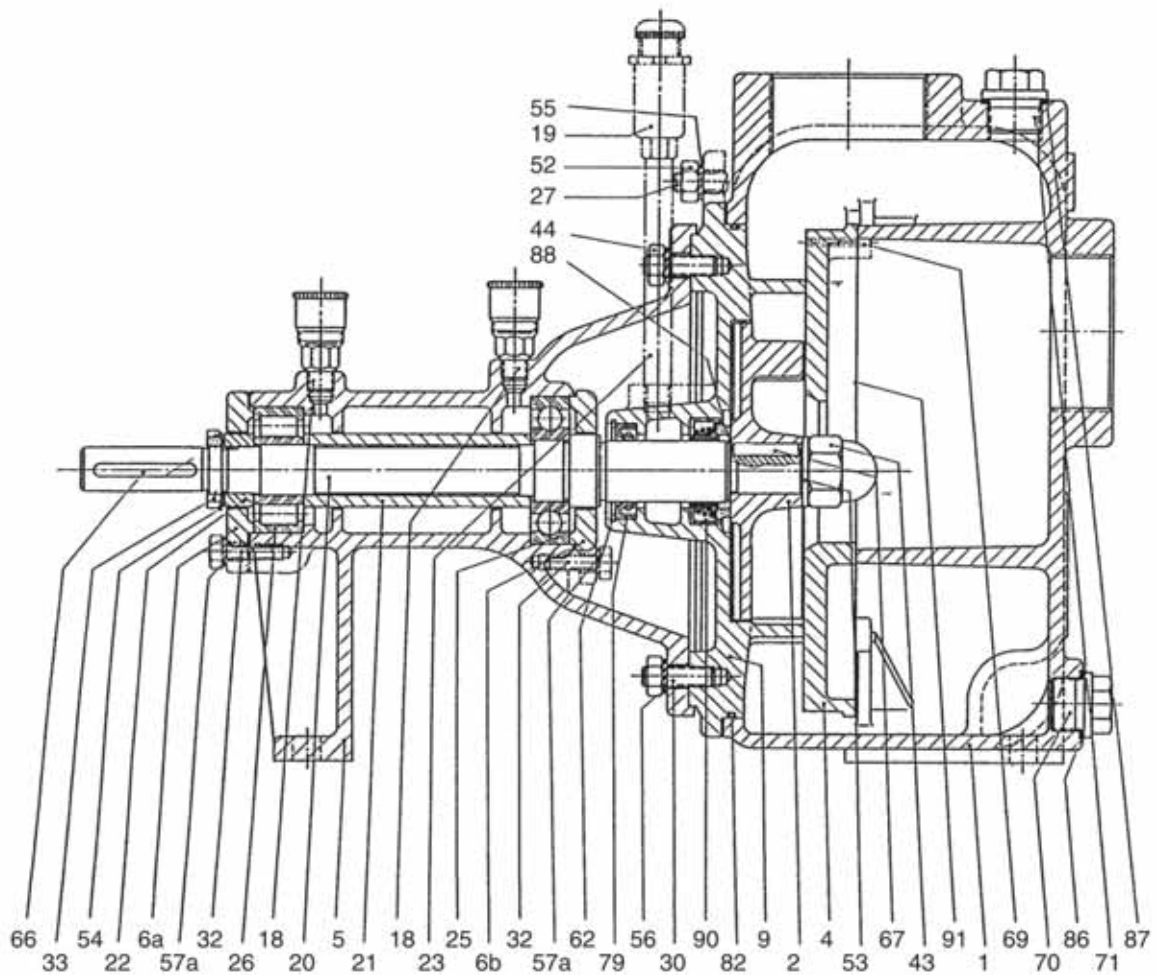

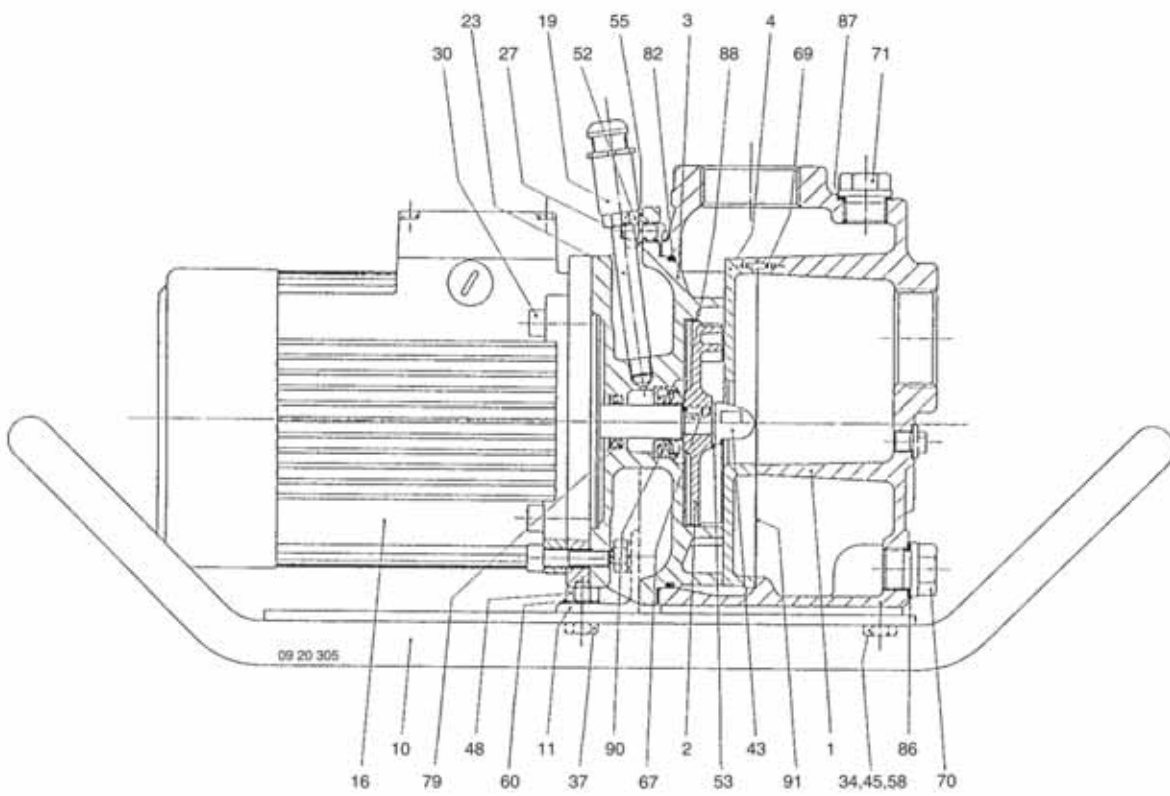

TM02 1904 2401

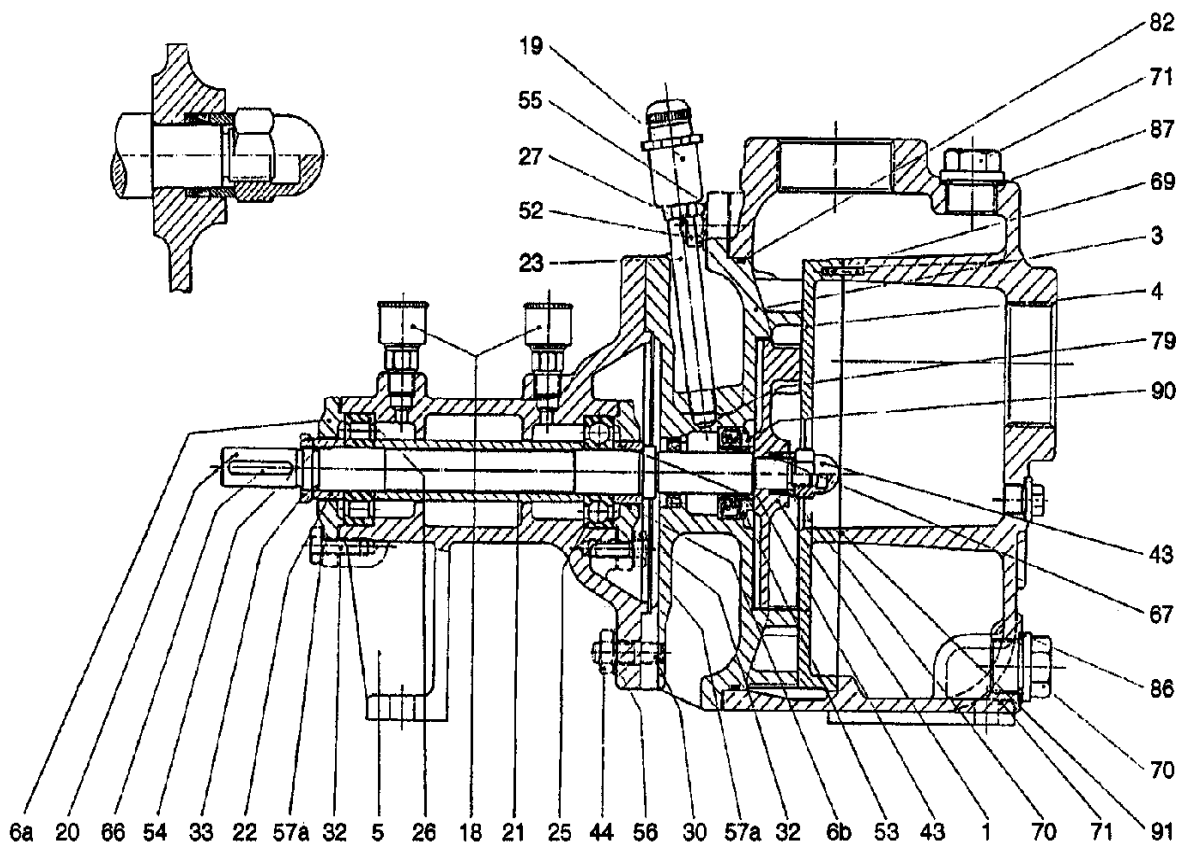

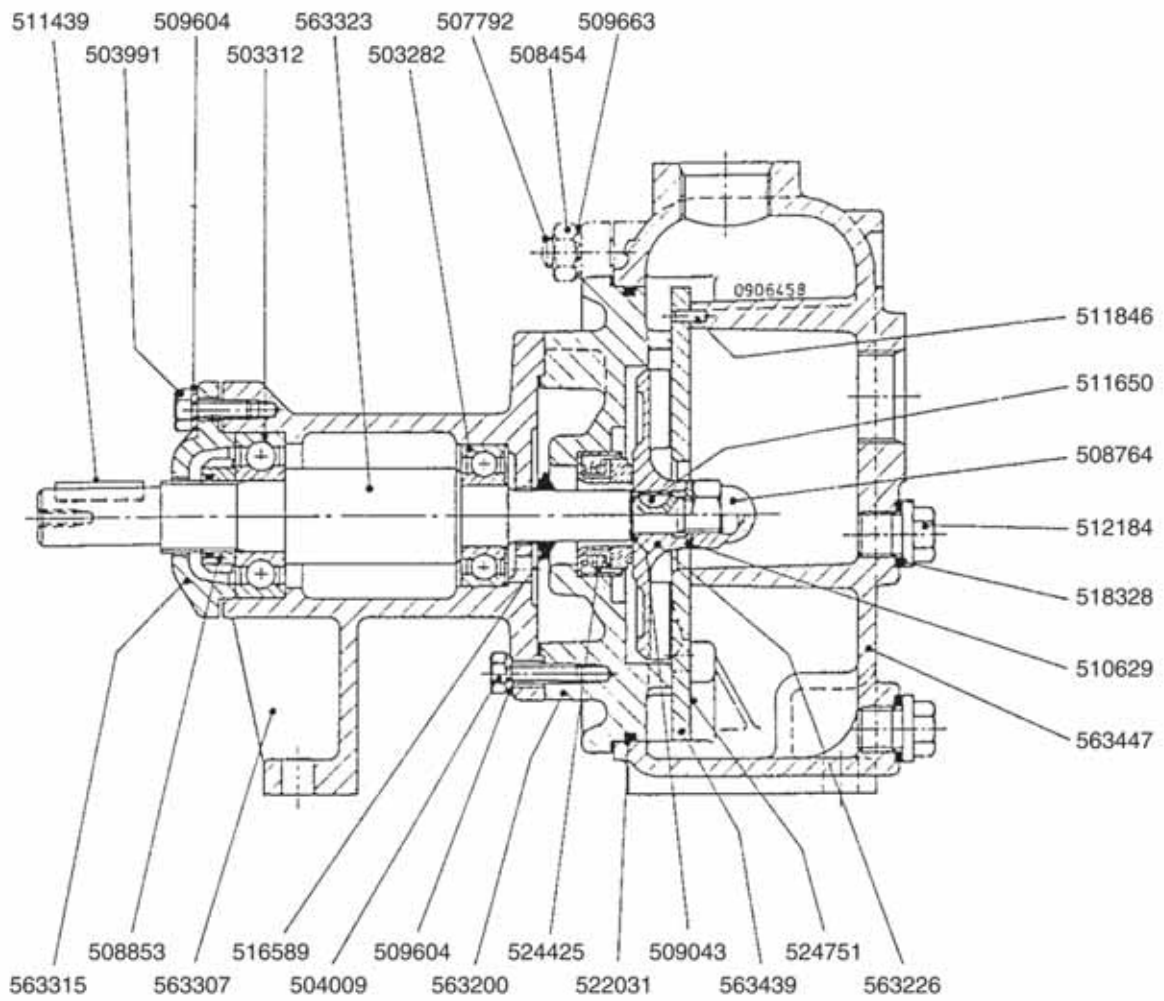

TM02.1906.2401